

EC小徑夾頭-BT柄

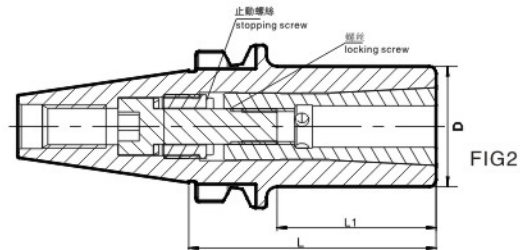
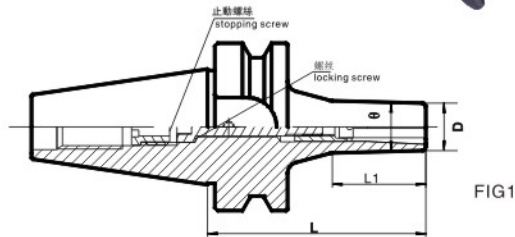

1. 跳動精度 < 0.005mm,
2. 最高轉速可達30000rpm;G2.5,
3. 沒有螺母的內藏式夾頭設計, 剛性強, 穩定性高。

訂貨型號-L	夾持範圍 ød	圖號 FIG	θ	L1	D	筒夾
BT30-EC06-60	3~6	1	3°	26	13	EC06
-90	3~6	1	3°	50	13	EC06
-EC08-130	3~8	1	3°	93	22	EC08
-EC12-70	3~12	2	--	45	34	EC12
-EC12-80	3~12	2	--	55	34	EC12
BT40-EC06-60	3~6	1	3°	26	13	EC06
-90	3~6	1	3°	45	13	EC06
-120	3~6	1	3°	60	13	EC06
-150	3~6	1	3°	76	13	EC06
-EC08-90	3~8	1	3°	53	22	EC08
-120	3~8	1	3°	65	22	EC08
-EC10-90	3~10	2	--	51	28	EC10
-120	3~10	2	--	81	28	EC10
EC12-70	3~12	2	--	35	34	EC12
-80	3~12	2	--	45	34	EC12
-90	3~12	2	--	55	34	EC12
-120	3~12	2	--	85	34	EC12
-150	3~12	2	--	110	34	EC12
BT50-EC10-110	3~10	2	--	57	28	EC10
-150	3~10	2	--	77	28	EC10
EC12-110	3~12	2	--	57	34	EC12
-150	3~12	2	--	80	34	EC12

UC筒夾刀柄-BT柄

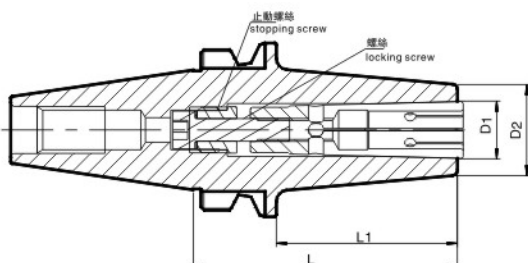

1. 跳動精度 < 0.005mm,
2. 適用於銑刀及銑刀同柄徑的鉸刀。
3. 沒有螺母的內藏式夾頭設計, 剛性強, 穩定性高。

訂貨型號-L	夾持範圍 ød	L1	D1	D2	筒夾 Collet
BT30-UC10-70	3~10	48	24	30	UC10
-UC16-70	6~16	48	32	40	UC16
BT40-UC10-90	3~10	63	24	32	UC10
-120	3~10	93	24	36	UC10
-150	3~10	123	24	40	UC10
-UC16-90	6~16	63	32	40	UC16
BT50-UC10-110	3~10	72	24	36	UC10
-200	3~10	162	24	50	UC10
-UC16-120	6~16	82	32	42	UC16

ER彈性筒夾刀柄-BT柄

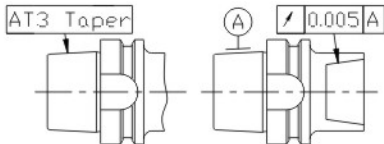
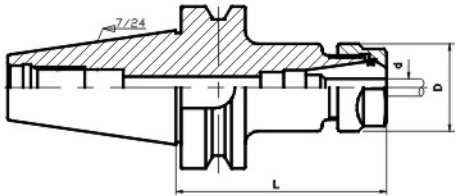

訂貨型號-L	ØD	夾持範圍 ød
BT30-ER11-60	19	1.0-7
-100		
-ER16-45		
-60	30	1.0-10
-100		
-ER20-60		
-100	34	2.0-13
-ER25-60		
-100		
-135	42	2.0-16
-ER32-60		
-100		
BT40-ER11-60	19	1.0-7
-100		
-ER16-60		
-100	30	1.0-10
-150		
-ER20-60		
-100	34	2.0-13
-150		
-200		
BT40-ER25-60	42	2.0-16
-100		
-135		
-150	50	2.0-20
-200		
-ER32-60		
-100	50	2.0-20
-150		
-200		

訂貨型號-L	ØD	夾持範圍 ød
BT40-ER32-200	50	2.0-20
-300		
-ER40-80		
-100	63	3.0-26
-150		
-200		
BT50-ER16-100	30	1.0-10
-150		
-ER20-100	34	2.0-13
-150		
-ER25-100	42	2.0-16
-150		
-ER32-100	50	2.0-20
-150		
-200		
-ER40-100	63	3.0-26
-150		
-200		
BT30-ER16-60M	23.5	1.0-10
-80M		
-100M		
-ER20-80M	28	2.0-13
-100M		
BT40-ER11-100M	17.5	1.0-7
-ER16-100M		
-150M		
-ER20-100M	23.5	1.0-10
-150M		
-ER20-100M	28	2.0-13
-150M		
BT50-ER16-150M	23.5	1.0-10

★ 以上規格均不含扳手、筒夾及拉釘，如有需要請另外訂購。

ER彈性筒夾刀柄-BT柄

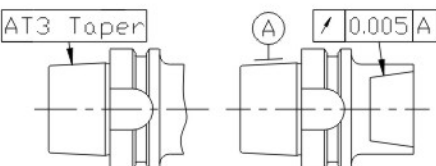
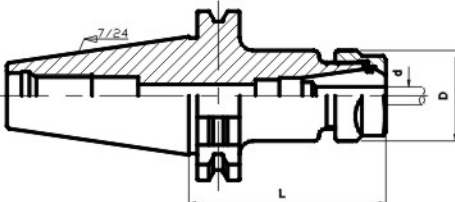

訂貨型號-L	ØD	夾持範圍 ød
SK40-ER16-60	30	1.0-10
-100		
-150		
-ER20-60	34	2.0-13
-100		
-120		
-150	42	2.0-16
-ER25-60		
-100		
-150	50	2.0-20
-ER32-70		
-100		
-150	63	3.0-26
-ER40-80		

訂貨型號-L	ØD	夾持範圍 ød
SK40-ER40-100	63	3.0-26
-150		
SK50-ER16-60	30	1.0-10
-100		
-150		
-ER20-100	34	2.0-13
-150		
-ER25-100	42	2.0-16
-150		
-ER32-100	50	2.0-20
-150		
-200		
-ER40-100	63	3.0-26
-150		

★ 以上規格均不含扳手、筒夾及拉釘，如有需要請另外訂購。

ER彈性筒夾刀柄-SKB柄



★ DIN69871 B型，可用于端面或中心給水

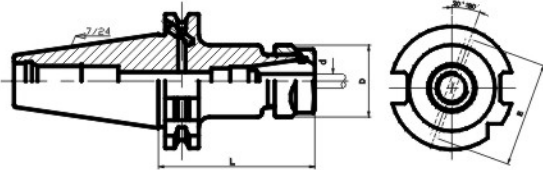

訂貨型號-L	ØD	夾持範圍 ød	訂貨型號-L	ØD	夾持範圍 ød
SK40B-ER16-60	30	1.0-10	SK40B-ER40-100	63	3.0-26
-100			-150		
-150			SK50B-ER16-60	30	1.0-10
-ER20-60	-100				
-100	-150				
-120	34	2.0-13	-ER20-100	34	2.0-13
-150			-150		
-ER25-60			-100	42	2.0-16
-100	-150				
-150	-ER25-100	-150			
-ER32-70	50	2.0-20	-ER32-100	50	2.0-20
-100			-150		
-150			-200		
-ER40-80	63	3.0-26	-ER40-100	63	3.0-26
			-150		

★ 以上規格均不含扳手、筒夾及拉釘，如有需要請另外訂購。

ER彈性筒夾刀柄-CAT柄

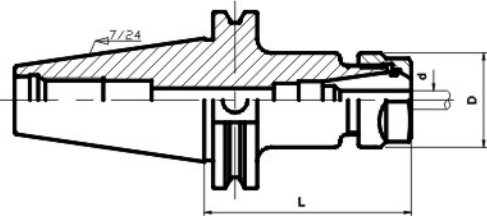

訂貨型號-L	ØD	夾持範圍 ød	訂貨型號-L	ØD	夾持範圍 ød
CAT40-ER16-2.5"	30	1.0-10	CAT50-ER16-4.0"	30	1.0-10
-4.0"			-6.0"		
-ER20-4.0"	34	2.0-13	-ER20-4.0"	34	2.0-13
-ER25-4.0"			-6.0"		
-ER32-3.0"	50	2.0-20	-ER25-4.0"	42	2.0-16
-5.0"			-ER32-4.0"		
-ER40-4.0"	63	3.0-26	-6.0"	50	2.0-20
			-ER40-4.0"		
			-6.0"	63	3.0-26

★ 以上規格均不含扳手、筒夾及拉釘，如有需要請另外訂購。

ER彈性筒夾刀柄-HSK柄

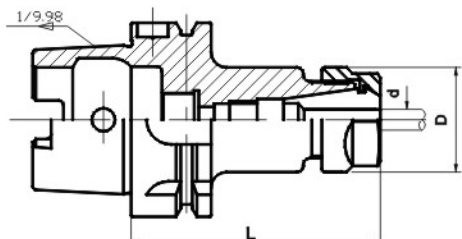

訂貨型號-L	ØD1	夾持範圍 ød	訂貨型號-L	ØD1	夾持範圍 ød
HSK-A63-ER16-100	30	0.5-10	HSK-A100-ER16-100	30	0.5-10
-150			-150		
-ER20-100	35	1.0-13	-ER20-100	35	1.0-13
-150			-150		
-ER25-100	42	1.0-16	-ER25-100	42	1.0-16
-150			-150		
-ER32-100	50	2.0-20	-ER32-100	50	2.0-20
-150			-150		
-ER40-100	63	3.0-26	-ER40-100	63	3.0-26
-150			-150		

標準平衡等級：16000rpm/G6.3。如有特別要求，平衡等級可達：24000rpm/G2.5

★ 以上規格均不含扳手、筒夾及冷卻水管，如有需要請另外訂購。

ER彈性筒夾刀柄-DIN2080柄

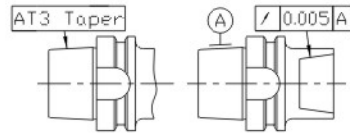
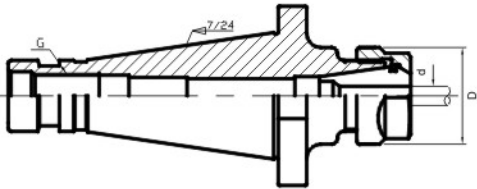

訂貨型號-L	ØD	夾持範圍 ød	G
DIN2080-30-ER32	50	2.0-20	M12
-ER40	63	3.0-26	
DIN2080-40-ER32	50	2.0-20	M16
-ER40	63	3.0-26	
DIN2080-50-ER32	50	2.0-20	M24
-ER40	63	3.0-26	

★ 以上規格均不含扳手、筒夾及拉釘，如有需要請另外訂購。

ER彈性筒夾刀柄-NT柄

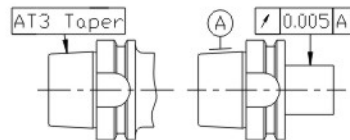
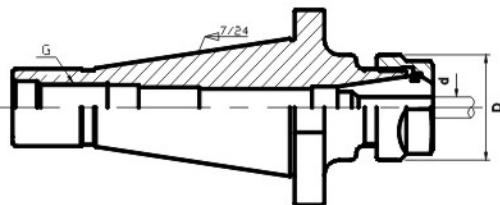

訂貨型號-L	ØD	夾持範圍 ød	G(inch)
NT30-ER32(12)*	50	2.0-20	1/2-12UNC
-ER32(13)*			1/2-13UNC
NT40-ER32	50	2.0-20	5/8-11UNC
-ER40	63	3.0-26	
NT50-ER32	50	2.0-20	1-8UNC
-ER40	63	3.0-26	

★ 以上規格均不含扳手及筒夾，如有需要請另外訂購。

SD精密彈性筒夾刀柄-SK柄

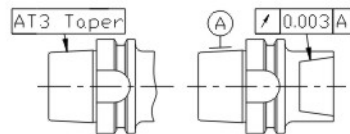
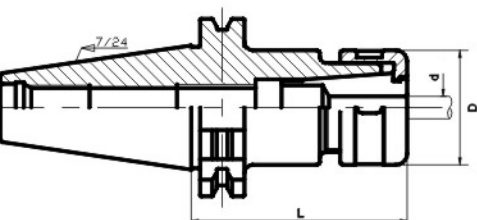

訂貨型號-L	øD	夾持範圍 ød
SK40-SD06-80	20	1.75-6.0
-SD10-80	29	1.75-10.0
-SD16-80	41	2.75-16
-SD20-80	50	4-20
SD25-80	55	6-25
SK50-SD06-100	20	1.75-6.0
-SD10-100	29	1.75-10.0
-SD16-100	41	2.75-16
-SD20-100	50	4-20
-SD25-100	55	6-25

★ 標配含扳手。★ 可更換使用SDP螺母

★ 以上規格均不含筒夾及拉釘，如有需要請另外訂購。

SD精密彈性筒夾刀柄-BT柄

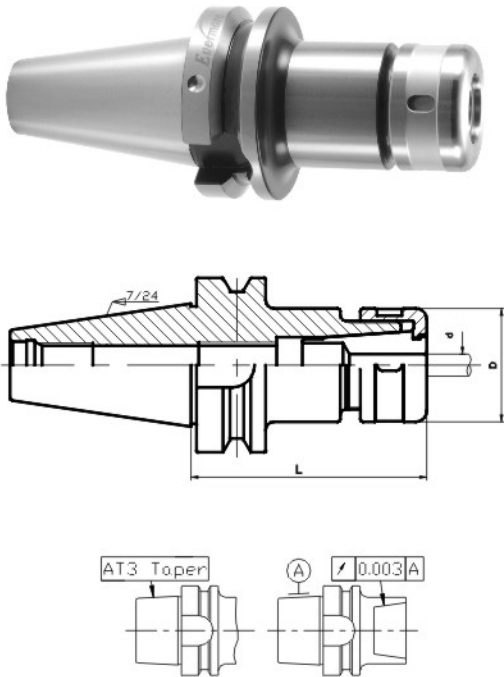

訂貨型號-L	∅D	夾持範圍 ∅d	訂貨型號-L	∅D	夾持範圍 ∅d
S20T-SD10-45	29	1.75~10.0	-SD20-60	50	4~20
BT30-SD06-60	20	1.75~6.0	-90		
-90	29	1.75~10.0	-120		
-SD10-60	29	1.75~10.0	-150		
-90	41	2.75~16	-SD25-90	55	6~25
-SD16-60					
-90					
-SD20-90	50	4~20	BT50-SD06-100	20	1.75~6.0
-SD25-90	55	6~25	-150	29	1.75~10.0
BT40-SD06-60	20	1.75~6.0	-SD10-100		
-90	29	1.75~10.0	-150	41	2.75~16
-120					
-SD10-60					
-90					
-120					
-150	50	4~20	-SD20-100	55	6~25
-SD16-60					
-90					
-120	41	2.75~16	-200	50	4~20
-150					
-SD25-100					
-90	55	6~25	-150	55	6~25
-120					
-150					

- ★ 標配含扳手。
- ★ 以上規格均不含筒夾及拉釘，如有需要請另外訂購。
- ★ 可更換使用SDP螺母

SD精密彈性筒夾刀柄-HSK柄

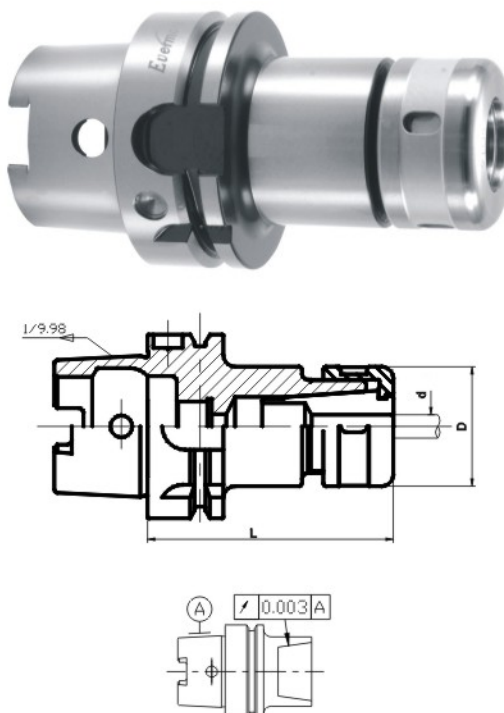

訂貨型號-L	∅D	夾持範圍 ∅d	訂貨型號-L	∅D	夾持範圍 ∅d
HSK-A32-SD10-60	29	1.75~10	-150	50	4~20
-90			SD25-100	55	6~25
HSK-A40-SD10-90			-150	55	6~25
HSK-A50-SD10-90	20	1.75~6	HSK-A100-SD06-100	20	1.75~6
HSK-A63-SD06-100			-150	29	1.75~10
-150	-SD10-100				
-SD10-80	29	1.75~10	-150	41	2.75~16
-100					
-150					
-SD16-80	41	2.75~16	SD16-100	50	4~20
-100					
-150					
-SD20-100	50	4~20	-SD20-100	55	6~25
-100	55	6~25	-150		
-150					

標準平衡等級：16000rpm/G6.3。如有特別要求，平衡等級可達：24000rpm/G2.5

- ★ 標配含扳手。
- ★ 以上規格均不含筒夾及冷却水管，如有需要請另外訂購。

OZ彈性筒夾刀柄-BT柄

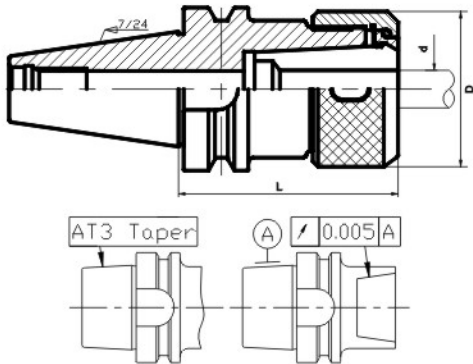

- ▶ OZ刀柄內孔採用單邊1/10角度厚壁設計，夾持力是普通筒夾刀柄的2-3倍。
- ▶ 可用于粗銑、精銑、鑽孔、鉸孔、攻牙等加工，因其夾持力大的結構特性，所以特別適合用于粗加工。
- ▶ 螺母中採用了鋼球滾動機構，減小筒夾磨損，提高夾持力。

訂貨型號-L	ØD	夾持範圍 ød
BT30-OZ25-70	60	6~25
BT40-OZ25-80	60	6~25
-100		6~25
-OZ32-80	78	6~32
BT50-OZ25-90	60	6~25
-150		6~25
-OZ32-90		6~25
-150	78	6~32

★ 以上規格均不含扳手、筒夾及拉釘，如有需要請另外訂購。

OZ彈性筒夾刀柄-SK柄

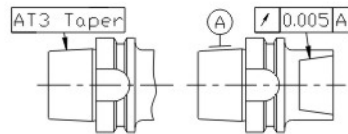
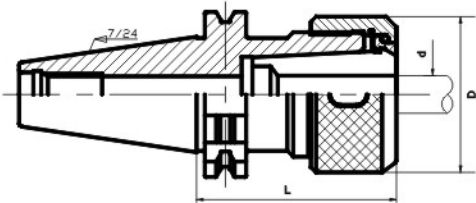

訂貨型號-L	ØD	夾持範圍 ød
SK40-OZ25-70	60	6~25
-OZ32-100	78	6~32
SK50-OZ25-80	60	6~25
-OZ32-80	78	6~32

★ 以上規格均不含扳手、筒夾及拉釘，如有需要請另外訂購。

OZ彈性筒夾刀柄-DIN2080柄

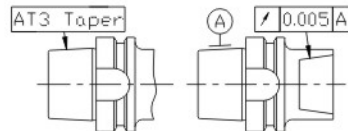
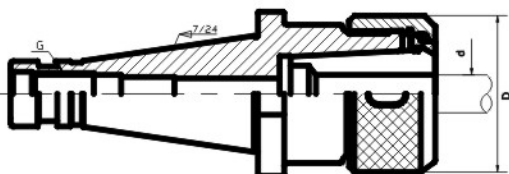

訂貨型號-L	ØD	夾持範圍 ød	G
DIN2080-30-OZ25	60	6~25	M12 × 1.75
DIN2080-40-OZ25	60	6~25	M16 × 2.0
-OZ32	78	6~32	
DIN2080-50-OZ25	60	6~25	M24 × 3.0
-OZ32	78	6~32	

★ 以上規格均不含扳手及筒夾，如有需要請另外訂購。

OZ彈性筒夾刀柄-NT柄

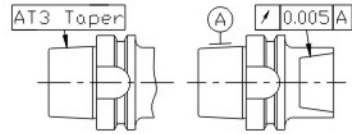
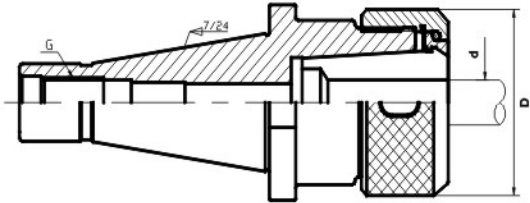

訂貨型號-L	ØD	夾持範圍 ø d	G(inch)
NT30-OZ25(12)*	60	6-25	1/2" -12UNC
-OZ25(13)*			1/2" -13UNC
NT40-OZ25	60	6-25	5/8" -11UNC
-OZ32	78	6-32	
NT50-OZ25	60	6-25	1" -8UNC
-OZ32	78	6-32	

★ 以上規格均不含扳手及筒夾，如有需要請另外訂購。

OZ彈性筒夾刀柄-HSK柄

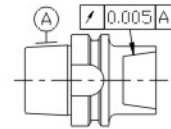
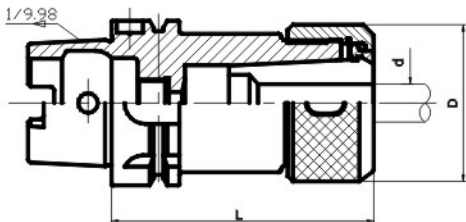

訂貨型號-L	ØD	夾持範圍 ø d
HSK-A63-OZ25-100	60	6-25
-OZ32-120	78	6-32
HSK-A100-OZ25-100	60	6-25
-OZ32-120	78	6-32

標準平衡等級：16000rpm/G6.3。
Standard balance:16000rpm/G6.3

★ 以上規格均不含扳手、筒夾及冷卻水管，如有需要請另外訂購。

EMC強力銑刀刀柄-BT柄

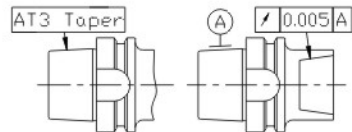
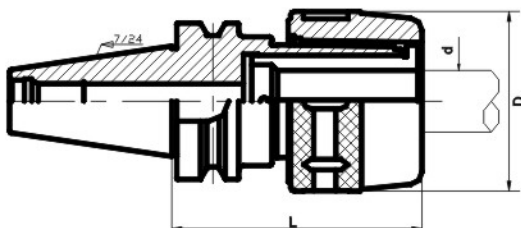

訂貨型號-L	ØD	夾持範圍 ø d
BT30-EMC20-80	53.5	6-20
BT40-EMC20-80	53.5	6-20
-135		
BT40-EMC32-90	73.5	6-32
-120		
BT50-EMC32-105	73.5	6-32
-135		
-165		
-EMC42-115	87.5	6-42

★ 單獨訂購均不帶筒夾及扳手，如有需要請另外訂購，也可訂購套裝產品（附帶筒夾7個及扳手1把）。

EMC強力銑刀刀柄-SK柄

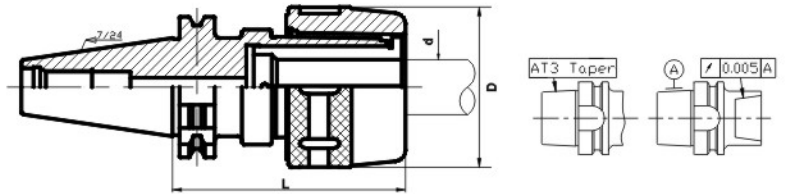

訂貨型號-L	ØD	夾持範圍 ød
SK40-EMC32-100	73.5	6-32
SK50-EMC32-100	73.5	6-32

★單獨訂購均不帶筒夾及扳手，如有需要請另外訂購，也可訂購套裝產品（附帶筒夾7個及扳手1把）。

EMC強力銑刀刀柄-CAT柄

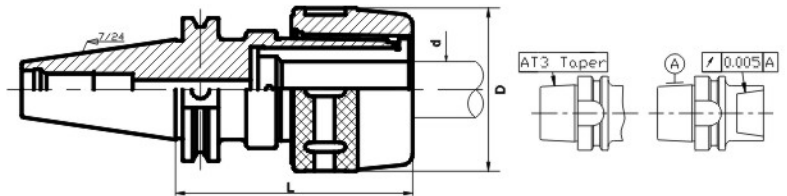

訂貨型號-L	ØD	夾持範圍 ød
CAT40-EMC32-4.0"	73.5	6-32
CAT50-EMC32-4.0"	73.5	6-32

★單獨訂購均不帶筒夾及扳手，如有需要請另外訂購，也可訂購套裝產品（附帶筒夾7個及扳手1把）。

EMC強力銑刀刀柄-DIN2080柄

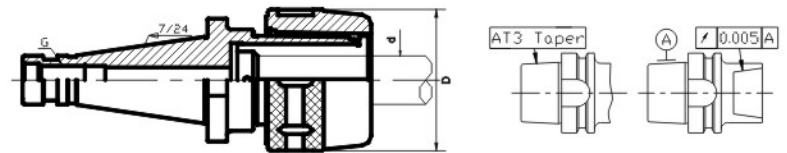

訂貨型號-L	ØD	夾持範圍 ød	G
DIN2080-40-EMC32	73.5	6-32	M16 × 2.0
DIN2080-50-EMC32	73.5	6-32	M24 × 3.0

★單獨訂購均不帶筒夾及扳手，如有需要請另外訂購，也可訂購套裝產品（附帶筒夾7個及扳手1把）。

EMC強力銑刀刀柄-HSK柄

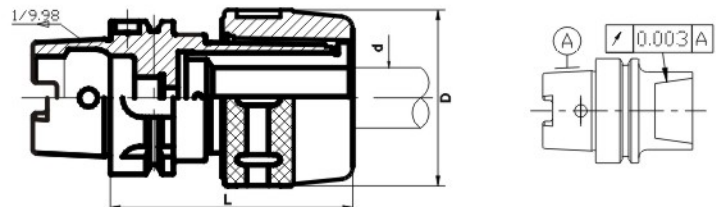

訂貨型號-L	ØD	夾持範圍 ød
HSK-A63-EMC32-100	73.5	6-32
HSK-A100-EMC32-110	73.5	6-32

標準平衡等級：16000rpm/G6.3。Standard balance:16000rpm/G6.3

★單獨訂購均不帶筒夾及扳手，如有需要請另外訂購，也可訂購套裝產品（附帶筒夾7個及扳手1把）。

C强力铣刀刀柄-BT柄

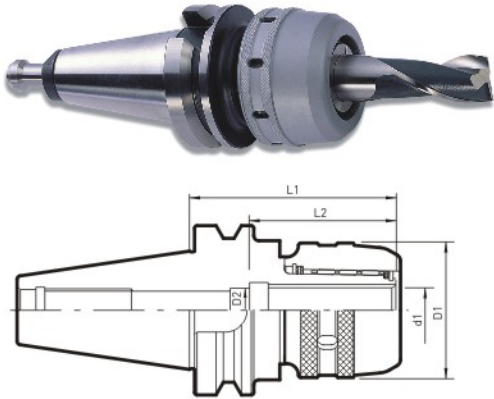

- 如要进行内部供油, 请使用ONK筒夹。

	订货型号-L	d1	D2	D1	L2		订货型号-L	d1	D2	D1	L2
BT30	C20-75	20	19	59	65	BT50	C20-105	20	19	59	65
	C20-90										
	C25-75										
	C20-80										
	C20-90										
C20-135											
C25-90	25	25	62	70	C32-110		32	25	75	75	
C25-135											
C32-90											
C32-105	32	25	75	75	C32-165						
C32-135											
						C32-200	42	25	94	85	
						C32-250					
						C32-300					
						C42-110					
						C42-135					
						C42-165					

C强力铣刀刀柄-SK柄

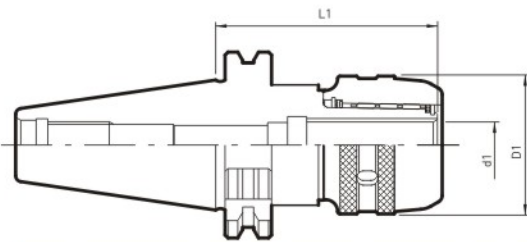

C强力铣刀刀柄-HSK柄

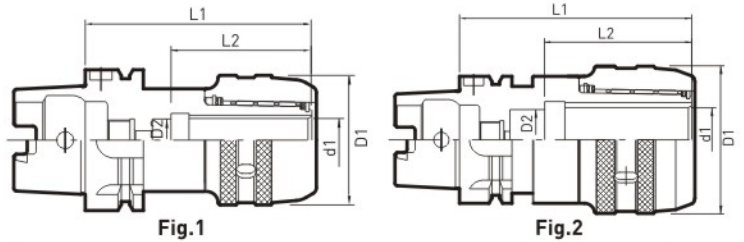

	订货型号-L	d1	D1		订货型号-L	d1	D1
SK40	C20-105	20	59	SK50	C32-105	32	75
	C25-105	25	62		C32-135		
	C32-105	32	75		C32-165		
	C32-135	32	75		C42-115		
SK50	C20-105	20	59	C42-135	42	94	
	C25-105	25	62	C42-165			

	订货型号-L	FIG	d1	D2	D1	L1	L2
HSK50A	C20-100	1	20	19	59	100	65
	C20-105	1	20	19	59	105	65
HSK63A	C32-130	2	32	25	75	130	75
	C20-110	1	20	19	59	110	65
HSK100A	C32-135	1	32	25	75	135	75
	C42-135	1	42	25	94	135	85

- 如要进行内部供油, 请使用ONK筒夹。

C强力铣刀刀柄-MT柄

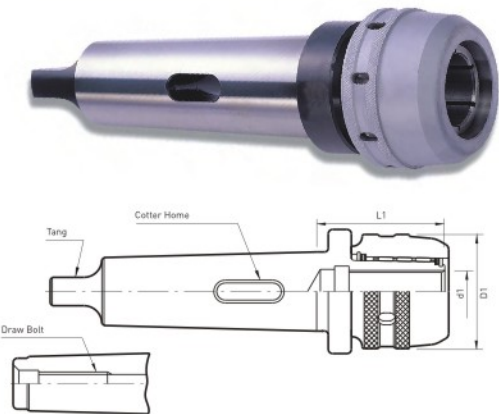

C强力铣刀刀柄-NT柄

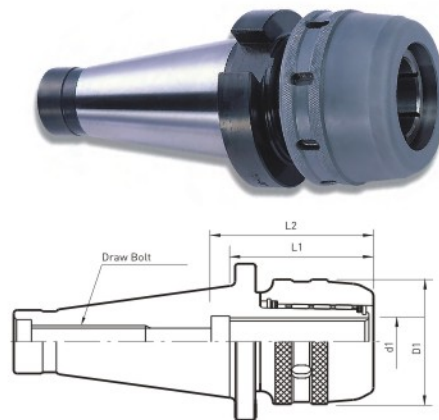

订货型号-L	d1	D1	Draw Bolt		COLLET
			METRIC		
MT4	C32-90	32	73	M16X2.0	K32
	C42-95	42	93	M16X2.0	K42
MT5	C32-90	32	73	M20X2.5	K32
	C42-95	42	93	M20X2.5	K42
MT6	C32-90	32	73	-	K32
	C42-95	42	93	-	K42

订货型号	d1	D1	L1	L2	Draw Bolt		COLLET	
					INCH	METRIC		
NT30	C20	20	58	62.6	65	1/2"-12UNC	M12X1.75	K20
NT40	C20	20	58	62.6	70	5/8"-11UNC	M16X2.0	K20
	C32	32	73	79.6	73	5/8"-11UNC	M16X2.0	K32
NT50	C32	32	73	76.7	90	1"-8UNC	M24X3.0	K32
	C42	42	93	86.2	110	1"-8UNC	M24X3.0	K42
NT60	C42	42	93	120.0	110	1 1/4"-7UNC	M30X3.5	K42



切削油方式

柄径内外均可使用切削油。

适用于高速加工

液压刀柄的动平衡力25,000rpm.保障了高速加工时的固定性和稳定性。

液压刀柄概要

我们常见的强力刀柄和ER刀柄等锁紧方式是用扳手转动刀头或螺帽使其夹紧。这个方法是比较常见的机械锁刀方法，但在保持刀具精度上有一定的局限性。我们的液压刀柄就很好的解决了这个问题，液压刀柄内部封闭的油压能使套筒膨胀，从而使内径全面贴紧切削工具。这种方式不仅使夹紧更简单，还提高了产品的固定度并且液压刀柄一体化的轻薄型态，更适合于高速加工（最高25000RPM），同时也保证了液压刀柄3-5μm的高精度。

液压刀柄使用时的优点

- 1) 最高的同心度
 - 在2.5*D1以内，使用筒夹时精度为5μ(max)，不使用筒夹时精度为3μ(max)
 - 切削作业时能更均匀地排屑，延长切削工具的寿命和提高工件的精密度和光泽度，并比一般刀柄延长切削工具寿命3倍以上。
- 2) 降低维修费用
 - 我公司的液压刀柄是全密封式液压系统，在切削作业时生成的切削油和工件内所产生的屑等杂物极少能渗透到刀柄内部，从根本上减少了刀柄的损害，从而延长了刀柄使用寿命，减少了维修费用。
- 3) 简便的手动锁紧方式
 - 采用与其他刀柄不同的T型扳手锁紧方式，比一般的锁紧方式更简便快捷，且减少了与切削工具的调整时间。
- 4) 最适合高速加工
 - 一体化外观的液压刀柄实现了无振动高速加工
- 5) 筒夹的使用，提高了刀柄的经济性
 - 开发高精度、高固定性的筒夹，一个刀柄可以与多种尺寸的筒夹一起使用，花最少的费用可以得到最经济的效果。

液压刀柄使用时的注意事项

1. 液压刀柄加压时，请用T型扳手将螺栓完全拧紧。(螺栓完全被拧紧时会停止，我公司液压刀柄的液压把持力在螺栓被完全拧紧时发挥的最好)
2. 切削工具插入时，请贴紧液压刀柄内径下端。因为加工深度不能完全贴紧时，请使用液压刀柄专用筒夹，未使用筒夹时，切削工具与刀柄内径下端(底部)的间隙不能超过8mm。(如果超过8mm，使用时刀柄内径会收缩)
3. 插入切削工具时，请去除刀柄内径和切削工具中的湿气和油水。(因为液体异物可能会导致切削工具脱离)
4. 请不要打开被封口的防空气螺栓。(若有漏油，将不能使用)
5. 请不要使用粗加工工具。
6. 若发生刀柄螺栓破损或不能正常转动等A/S情况时，请不要随意拆分刀柄，或插入异物，请及时与刀柄销售商联系。

(因人为原因导致的刀柄问题，我们将按情况收取维修费)

- 加紧切削工具时，φ6~φ32切削工具柄部要使用能插入工具公差h6的工具。
- 使用液压刀柄φ12，φ20，φ32时，可以用D或OD筒夹使用各种尺寸的切削工具。

切削工具SHANK Ø 区分	Ø3-6	Ø6.1-10	Ø10.1-14	Ø14.1-18	Ø18.1-24	Ø24.1-30	Ø30.1-40
h6	0-8um	0-9um	0-11um	0-11um	0-13um	0-13um	0-16um

(以上图表是液压刀柄使用时，切削工具柄径的基准公差。)

适用工具

铣刀、钻头、铰刀等高精度工具

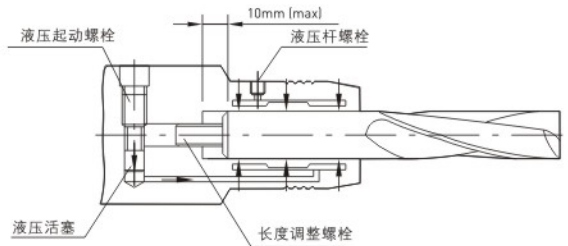

5μm以内高精度

由于液压刀柄同心度为5μm以内，作业时可有效提高加工效率，延长工具的寿命。

可使用多种内径尺寸的D/OD筒夹

可通过T扳手,简便地交换工具

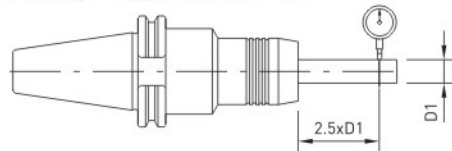

JHM液压刀柄-BT柄

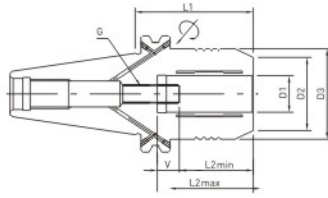

订货型号-L		D1	D2	D3	L2max	L2min
BT30	JHM20P - 85	20	40	44	52.5	42.5
BT40	JHM20P - 72.5			49.5		
BT50	JHM32P - 90	32	60	72	65	55



订货型号-L		D1	D2	D3	D4	L2max	L2min	L3
BT30	JHM 6 - 70	6	25	28	45	37.5	27.5	28
	JHM 8 - 70	8	27	30		42.5	32.5	38
	JHM10 - 75	10	29	32		47.5	37.5	36
	JHM12 - 75	12	31	34		52.5	42.5	44
	JHM14 - 85	14	33	36	-	52.5	42.5	48
	JHM16 - 90	16	35	38				
	JHM18 - 90	18	38	41				
	JHM20 - 90	20	40	43				

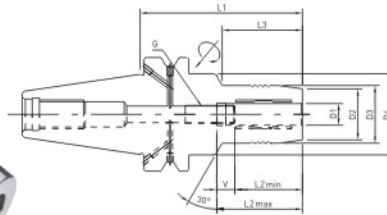
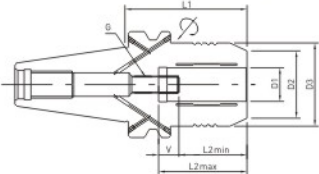

Fig1

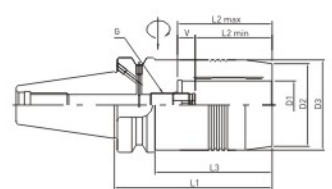

Fig2

Taper AT3 T_{LR} ≥2.5μ/2.5φ Bal./rpm G2.5/2000 Coolant AD, AD/B

订货型号-L		D1	D2	D3	D4	L2max	L2min	L3	Type					
BT40	JHM 6 - 65	6	25	28	50	37.5	27.5	23	Fig1					
	JHM 6 - 90							44						
	JHM 6 - 140							23						
	JHM 8 - 65	8	27	30		44								
	JHM 8 - 90					23								
	JHM 8 - 140					44								
	JHM 10 - 65	10	29	32		23								
	JHM 10 - 90					42.5	32.5	44						
	JHM 10 - 140					23								
	JHM 12 - 65	12	31	34		50	47.5	37.5		23	Fig1			
	JHM 12 - 90									44				
	JHM 12 - 140									23				
	JHM 14 - 65	14	33	36	23									
	JHM 14 - 90				44									
	JHM 14 - 140				23									
	JHM 16 - 65	16	35	38	50		52.5	42.5	23	Fig1				
	JHM 16 - 90								48					
	JHM 16 - 140								30					
	JHM 18 - 75	18	38	41			50	52.5	42.5			30	Fig1	
	JHM 18 - 90											48		
	JHM 18 - 140											30		
	JHM 20 - 75	20	40	43		50		61	51		30	Fig2		
	JHM 20 - 90										48			
	JHM 20 - 140										73			
JHM 25 - 100	25	53	57	-				65	55		108			Fig2
JHM 25 - 135											78			
JHM 32 - 105											108			
JHM 32 - 135	32	58	63		78			108						

Taper AT3 T_{LR} ≥2.5μ/2.5φ Bal./rpm G2.5/15000 Coolant AD, AD/B

订货型号-L		D1	D2	D3	D4	L2max	L2min	L3	Type						
BT50	JHM 6 - 90	6	25	28	50	37.5	27.5	23	Fig1						
	JHM 6 - 120							44							
	JHM 6 - 140							32							
	JHM 8 - 90	8	27	30		50	42.5	32.5		44	Fig1				
	JHM 8 - 120									32					
	JHM 8 - 140									44					
	JHM 10 - 90	10	29	32			50	47.5		37.5		32	Fig1		
	JHM 10 - 120											44			
	JHM 10 - 140											32			
	JHM 12 - 90	12	31	34				50		52.5		42.5		44	Fig1
	JHM 12 - 120													32	
	JHM 12 - 140													44	
	JHM 14 - 90	14	33	36	50				61	51		32		Fig2	
	JHM 14 - 120											48			
	JHM 14 - 140											30			
	JHM 16 - 90	16	35	38		-			65	55	32	Fig2			
	JHM 16 - 120										48				
	JHM 16 - 140										30				
	JHM 18 - 90	18	38	41			-		77	55	48		Fig2		
	JHM 18 - 120										48				
	JHM 18 - 140										30				
	JHM 20 - 90	20	40	43				-	112	55	48				Fig2
	JHM 20 - 120										77				
	JHM 20 - 140										112				
	JHM 25 - 105	25	53	57	-				112	55	67			Fig2	
	JHM 25 - 150										112				
	JHM 32 - 115										77				
	JHM 32 - 150	32	-	63		112									

JHM液压刀柄-SK柄

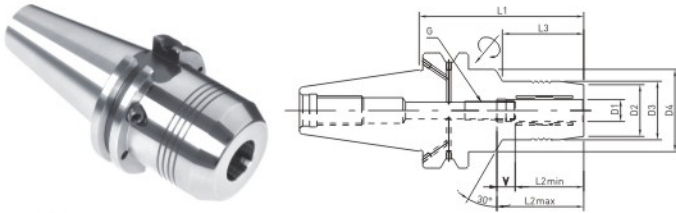

订货型号-L	D1	D2	D3	L2max	L2min
SK40 JHM20P - 64.5	20	40	49.5	52.5	42.5
SK50 JHM32P - 81	32	60	72	65	55



Taper AT3 T.I.R ≥5μm/2.5xD Bal./rpm G2.5/20000 Coolant AD, AD/B

订货型号-L	D1	D2	D3	D4	L2max	L2min	L3	Type		
JHM 6 - 65	6	25	28	50	37.5	27.5	23	Fig1		
JHM 6 - 80.5							44			
JHM 6 - 110							23			
JHM 8 - 65	8	27	30				44			
JHM 8 - 80.5							23			
JHM 8 - 110							44			
JHM10 - 65	10	29	32		42.5	32.5	23			
JHM10 - 80.5					44					
JHM10 - 110					23					
JHM12 - 65	12	31	34		47.5	37.5	44			
JHM12 - 80.5							23			
JHM12 - 110							44			
JHM14 - 75	14	33	36	52.5			42.5	30		
JHM14 - 80.5								48		
JHM14 - 110								30		
JHM16 - 75	16	35	38		61.0	51.0		48		
JHM16 - 80.5								30		
JHM16 - 110								48		
JHM18 - 75	18	38	41	65.0			55.0	48		
JHM18 - 80.5								30		
JHM18 - 135								48		
JHM20 - 75	20	40	43		65.0	55.0		30		
JHM20 - 80.5								48		
JHM20 - 110								48		
JHM25 - 80.5	25	53	57	66			61.0	51.0	26	Fig2
JHM32 - 80.5	32	60	63	80			65.0	55.0	26	

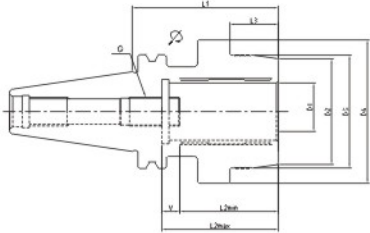
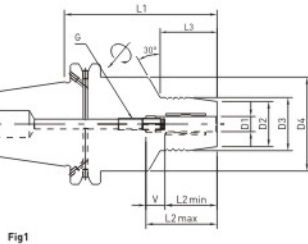

Taper AT3 T.I.R ≥5μm/2.5xD Bal./rpm G2.5/15000 Coolant AD, AD/B

订货型号-L	D1	D2	D3	D4	L2max	L2min	L3	Type				
JHM 6 - 90	6	25	28	50	37.5	27.5	44	Fig1				
JHM 6 - 140							44					
JHM 8 - 90							8		27	30	44	
JHM 8 - 140	44											
JHM10 - 90	10	29	32								44	
JHM10 - 140							44					
JHM12 - 90					12	31	34		44			
JHM12 - 140	47.5	37.5	44									
JHM14 - 90			44									
JHM14 - 140			44									
JHM16 - 90			16		35	38	48					
JHM16 - 140							48					
JHM18 - 90				18			38	41	48			
JHM18 - 140	48											
JHM20 - 80.5	20	40	43		52.5	42.5			48			
JHM20 - 90				48								
JHM20 - 110				48								
JHM20 - 140				48								
JHM25 - 105				25			53	57	61.0	51.0	85.9	Fig2
JHM25 - 140											130.9	
JHM32 - 115	32	58	63		95.9							
JHM32 - 140				130.9								

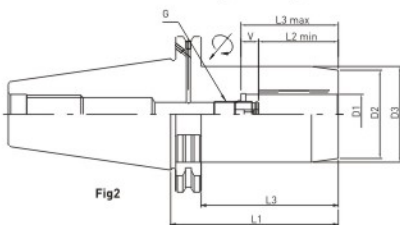
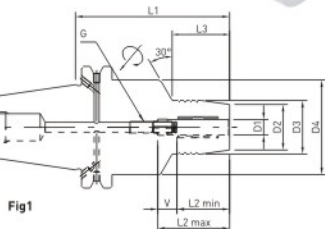

JHM液压刀柄-HSK柄

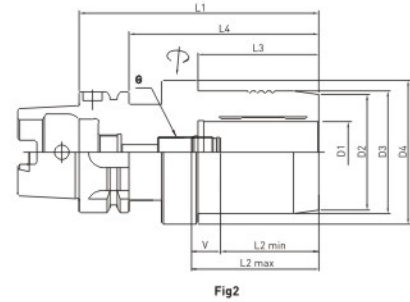
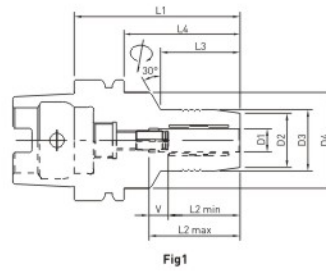

Taper

AT3

T,I,R

≥5μm/2.5xD

Bal./rpm

G2.5/20000

Coolant

AD

mm

訂貨型號-L		D1	D2	D3	D4	L1	L2max	L2min	V	L3	L4	G	Type							
HSK40A	JHM 6 - 70	6	25	28	34	70	37.5	27.5	10	28	50	M5X0.8	Fig1							
	JHM 8 - 70	8	27	30		75	42.5	32.5		34	55	M6X1.0								
	JHM10 - 75	10	29	32		80	47.5	37.5		40	60	M6X1.0								
HSK50A	JHM12 - 85	12	31	34	40	70	37.5	27.5		28	44	M5X0.8	Fig1							
	JHM 6 - 70	6	25	28		75	42.5	32.5		34	49	M5X0.8								
	JHM 8 - 70	8	27	30		85	47.5	37.5		44	59	M8x1.0								
	JHM10 - 80	10	29	32		60	90	52.5		42.5	30	64		M8x1.0						
	JHM12 - 85	12	31	34	62		90	52.5		42.5	30	64	M8x1.0							
	JHM14 - 85	14	33	36																
	HSK63A	JHM16 - 90	16	35	38	50	90	52.5		42.5	10	64	M8x1.0	Fig1						
JHM18 - 90		18	38	41																
JHM20 - 90		20	40	43																
JHM 6 - 70		6	25	28	63				120						61	51	24	44	M5X0.8	Fig1
JHM 8 - 70		8	27	30													35	54	M6X1.0	
JHM10 - 80		10	29	32													40	59	M8X1.0	
HSK100A		JHM12 - 85	12	31	34				50						95	47.5	37.5	10	46	64
		JHM14 - 85	14	33	36	47														
		JHM16 - 90	16	35	38	48														
		JHM18 - 90	18	38	41	59	94	M16x1.0												
	JHM20 - 90	20	40	43	75	125	65	55	63	99	M16x1.0	Fig2								
	JHM25 - 120	25	53	57					63	110	61		51	59	94	M16x1.0				
	JHM32 - 125	32	58	63										63	94	M16x1.0				
	HSK100A	JHM 6 - 75	6	25	28	50	75	37.5	27.5	10	46	66	M8x1.0	Fig1						
		JHM 8 - 75	8	27	30															
		JHM10 - 90	10	29	32															
JHM12 - 95		12	31	34																
JHM14 - 95		14	33	36																
JHM16 - 100		16	35	38	100										52.5	42.5	71	M8x1.0		
JHM18 - 100		18	38	41																
JHM20 - 105		20	40	43																
JHM25 - 110		25	53	57	63										110	61	51	10	76	M8x1.0
JHM32 - 110	32	58	63	63		81	M8x1.0													

JHM液压刀柄-HSK柄

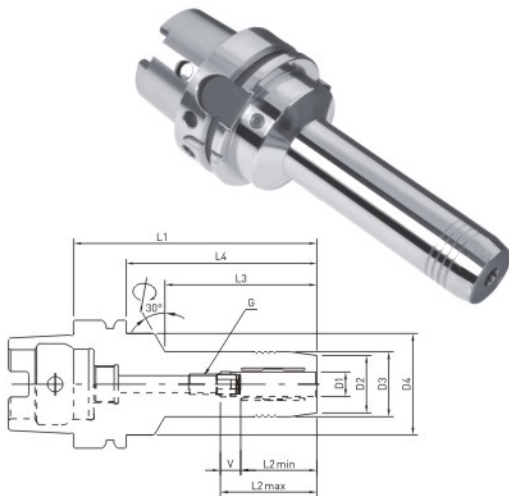

Taper AT3 T.I.R. $\geq 5\mu\text{m}/2.5\text{xD}$ Bal./rpm G2.5/20000 Coolant AD mm

訂貨型號-L	D1	D2	D3	D4	L2max	L2min	L3	L4
JHM 6 - 150	6	25	28	50	37.5	27.5	103	124
JHM 6 - 200							103	174
JHM 8 - 150	8	27	30				104	124
JHM 8 - 200							104	174
JHM10 - 150	10	29	32		42.5	32.5	104	124
JHM10 - 200					104	174		
JHM12 - 150	12	31	34		47.5	37.5	105	124
JHM12 - 200							105	174
JHM14 - 150	14	33	36				105	124
JHM14 - 200							105	174
JHM16 - 150	16	35	38		52.5	42.5	106	124
JHM16 - 200							106	174
JHM18 - 150	18	38	41	107			124	
JHM18 - 200				107			174	
JHM20 - 150	20	40	43	52.3	42.5	108	124	
JHM20 - 200						108	174	

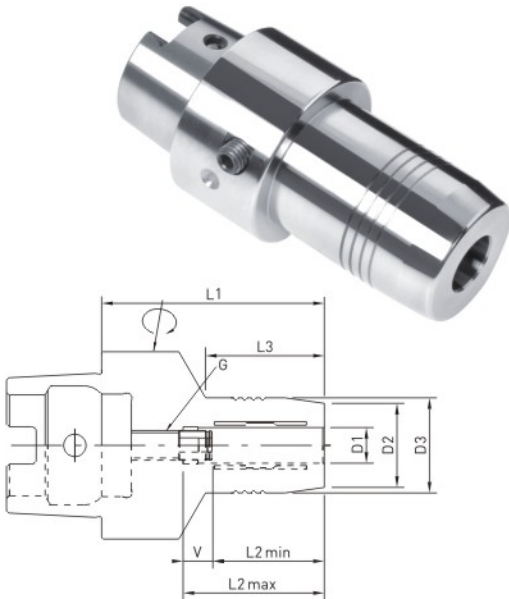

Taper AT3 T.I.R. $\geq 5\mu\text{m}/2.5\text{xD}$ Bal./rpm G2.5/20000 Coolant AD mm

訂貨型號-L	D1	D2	D3	L2max	L2min	L3
JHM 6 - 60	6	25	28	37.5	27.5	35
JHM 8 - 60	8	27	30			36
JHM10 - 65	10	29	32			41
JHM12 - 70	12	31	34	47.5	37.5	47
JHM 6 - 60	6	25	28	37.5	27.5	30
JHM 8 - 60	8	27	30			30
JHM10 - 65	10	29	32	42.5	32.5	35
JHM12 - 75	12	31	34			44
JHM14 - 75	14	33	36	47.5	37.5	46
JHM16 - 80	16	35	38			51
JHM18 - 80	18	38	41	52.5	42.5	51
JHM20 - 80	20	40	43			52

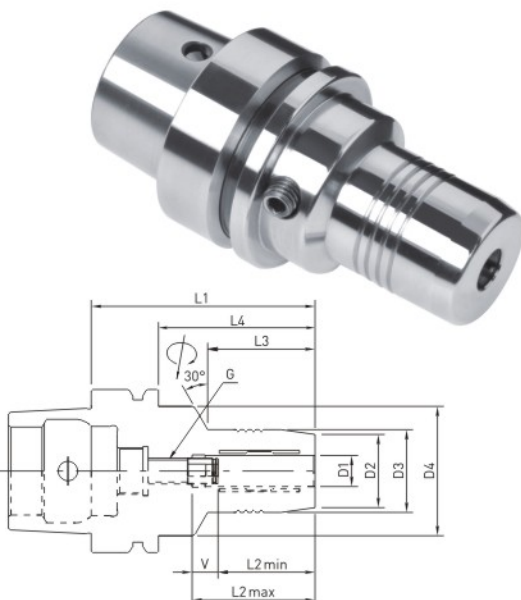

Taper AT3 T.I.R. $\geq 5\mu\text{m}/2.5\text{xD}$ Bal./rpm G2.5/20000 Coolant AD mm

訂貨型號-L	D1	D2	D3	D4	L2max	L2min	L3	L4
JHM 6 - 75	6	25	28	34	37.5	27.5	28	50
JHM 8 - 70	8	27	30					55
JHM10 - 75	10	29	32		42.5	32.5	34	55
JHM12 - 85	12	31	34		47.5	37.5	-	60
JHM 6 - 70	6	25	28	40.0	37.5	27.5	28	44
JHM 8 - 70	8	27	30					49
JHM10 - 80	10	29	32		42.5	32.5	34	49
JHM12 - 85	12	31	34		47.5	37.5	44	59
JHM16 - 90	16	35	38	60	52.5	42.5	30	64
JHM20 - 90	20	40	43				62	

JHM齿轮液压刀柄-BT柄

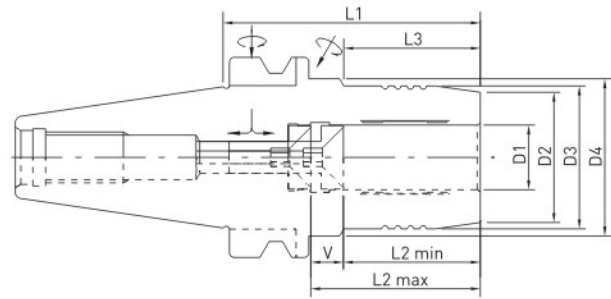

Taper AT3 T.I.R. $\geq 5\mu\text{m}/2.5xD$ Bal./rpm G2.5/20000 Coolant AD, AD/B mm

訂貨型號-L		D1	D2	D3	D4	L1	L2 max	L2 min	V	L3
BT40	JHM20G - 90	20	40	43	50	90	52.5	42.5	10	50
BT50	JHM20G - 90	20	40	43	50	85	52.5	42.5	10	32

JHM齿轮液压刀柄-SK柄

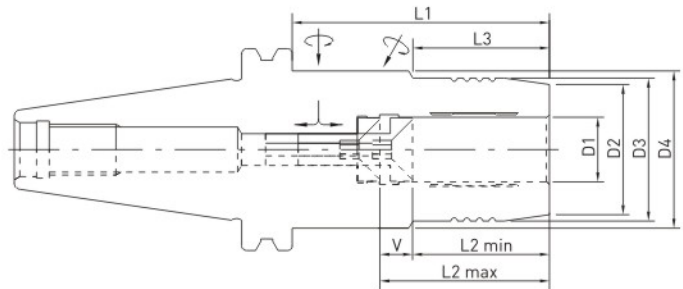

Taper AT3 T.I.R. $\geq 5\mu\text{m}/2.5xD$ Bal./rpm G2.5/20000 Coolant AD, AD/B mm

訂貨型號-L		D1	D2	D3	D4	L1	L2 max	L2 min	V	L3
SK40	JHM20G - 85	20	40	43	50	85	52.5	42.5	10	50
SK50	JHM20G - 85	20	40	43	50	85	52.5	42.5	10	32

JHM齿轮液压刀柄-HSK柄

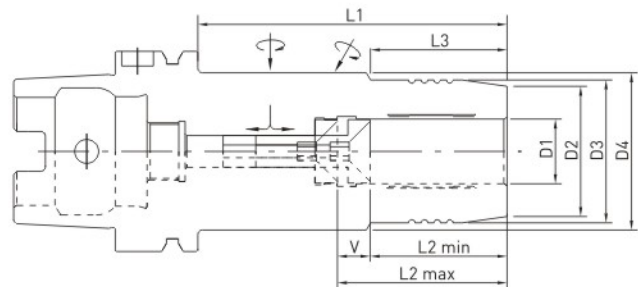

Taper AT3 T.I.R. $\geq 5\mu\text{m}/2.5xD$ Bal./rpm G2.5/20000 Coolant AD mm

訂貨型號-L		D1	D2	D3	D4	L1	L2max	L2min	V	L3	L4
HSK63A	JHM12G - 95	12	31	34	50.0	95	47.5	37.5	10	42	69
	JHM20G - 100	20	40	43		100	52.5	42.5		50	74
HSK100A	JHM12G - 105	12	31	34		105	47.5	37.5		42	76
	JHM20G - 110	20	40	43		110	52.5	42.5		50	81
	JHM32G - 120	32	60	63		75.0	120	65		55	61

SHR热缩刀柄-BT柄

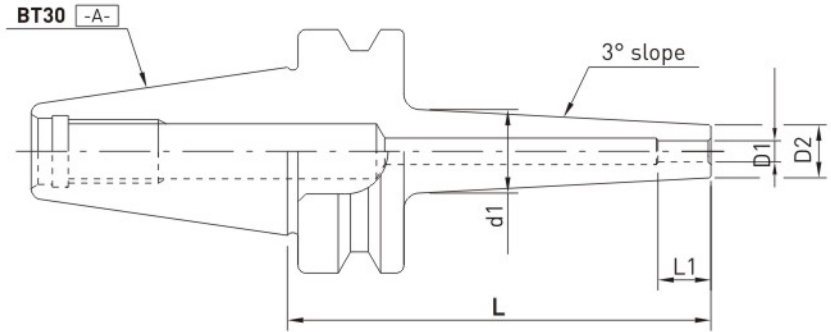

Taper AT3 T.I.R $\geq 3\mu\text{m}/2.5\text{xD}$ Bal./rpm G2.5/20000 Coolant AD, AD/B For Solid Carbide

mm

訂貨型號-L	Ød1	D1	D2	L1	L	
BT30	SHR 3 - 80	14.8	3	9	9	80
	SHR 4 - 80	15.8	4	10	12	
	SHR 5 - 80	16.8	5	11	15	
	SHR 6 - 80	17.8	6	12	25	
	SHR 8 - 80	19.8	8	14		
	SHR10 - 80	21.8	10	16	32	
	SHR12 - 80	23.8	12	18	38	
	SHR14 - 80	25.8	14	20	40	90
	SHR16 - 90	27.8	16	22		
	SHR18 - 90	29.8	18	24	42	
SHR20 - 90	31.8	20	26	44		
BT40	SHR 3 - 90	17	3	9	9	90
	SHR 4 - 90	18	4	10	12	
	SHR 5 - 90	19	5	11	15	
	SHR 6 - 90	20	6	12	25	
	SHR 8 - 90	22	8	14		
	SHR10 - 90	24	10	16	32	
	SHR12 - 90	26	12	18	38	
	SHR14 - 90	28	14	20	40	95
	SHR16 - 90	30	16	22		
	SHR18 - 95	32	18	24	42	
	SHR20 - 95	34	20	26	44	100
SHR25 - 100	39	25	31	50		
BT50	SHR 6 - 100	20.4	6	12	25	100
	SHR 8 - 100	22.4	8	14		
	SHR10 - 100	24.4	10	16		
	SHR12 - 100	26.4	12	18	38	
	SHR14 - 100	28.4	14	20		
	SHR16 - 100	30.4	16	22	40	
	SHR18 - 100	32.4	18	24		
	SHR20 - 100	34.4	20	26	44	
	SHR25 - 100	39.4	25	31	50	
SHR32 - 100	46.4	32	38			

切削工具SHANKØ 区分	Ø3 - 6	Ø6.1 - 10	Ø10.1 - 14	Ø14.1 - 18	Ø18.1 - 24	Ø24.1 - 30	Ø30.1 - 40
h6	0 - 8µm	0 - 9µm	0 - 11µm	0 - 11µm	0 - 13µm	0 - 13µm	0 - 16µm

SHR热缩刀柄-HSK柄

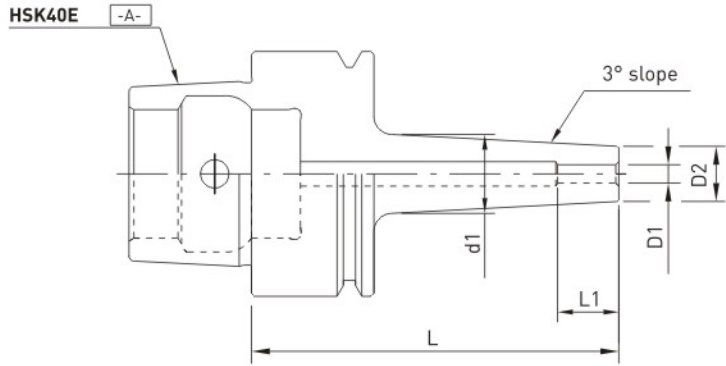

Taper AT3 T.I.R. $\geq 3\mu\text{m}/2.5xD$ Bal./rpm G2.5/20000 Coolant AD For Solid Carbide

mm

訂貨型號-L		Ød1	D1	D2	L1	L
HSK40E	SHR 3 - 60	19	3	9	9	60
	SHR 3 - 120					120
	SHR 4 - 60	20	4	10	12	60
	SHR 4 - 120					120
	SHR 5 - 60	21	5	11	15	60
	SHR 5 - 120					120
	SHR 6 - 80	22	6	12	25	80
	SHR 6 - 120					120
	SHR 8 - 80	24	8	14		80
	SHR 8 - 120					120
	SHR10 - 80	26	10	16	32	80
	SHR10 - 120					120
	SHR12 - 90	28	12	18	38	90
	SHR12 - 120					120
HSK50E	SHR 4 - 60	18.6	4	10	12	60
	SHR 5 - 60	19.6	5	11	15	
	SHR 6 - 60	19.6	6	12	25	80
	SHR 8 - 80	21.6	8	14		120
	SHR 8 - 120					80
	SHR10 - 80	23.6	10	16		120
	SHR12 - 85	25.6	12	18	38	85
	SHR12 - 120					120
	SHR14 - 90	27.6	14	20		90
	SHR14 - 120					120
	SHR16 - 90	29.6	16	22	40	90
	SHR16 - 120					120
	SHR18 - 95	31.6	18	24	42	95
	SHR18 - 120					120
	SHR20 - 100	31.6	20	26	44	100
	SHR20 - 120					120

切削工具SHANKØ 区分	Ø3 - 6	Ø6.1 - 10	Ø10.1 - 14	Ø14.1 - 18	Ø18.1 - 24	Ø24.1 - 30	Ø30.1 - 40
h6	0 - 8µm	0 - 9µm	0 - 11µm	0 - 11µm	0 - 13µm	0 - 13µm	0 - 16µm

SHR热缩刀柄-HSK柄

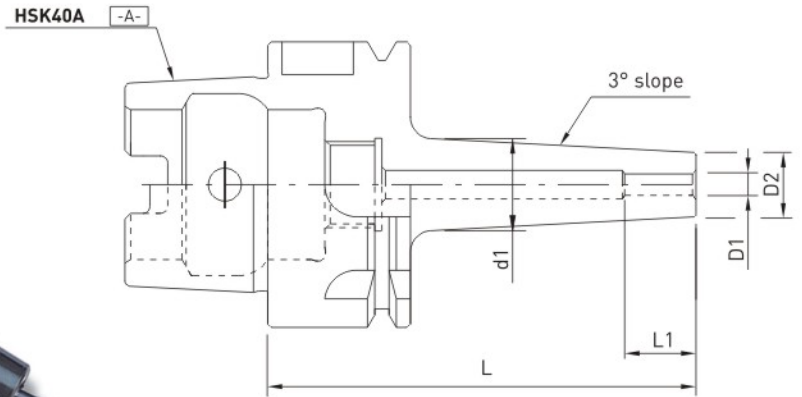

Taper AT3 T.I.R. $\geq 3\mu\text{m}/2.5\text{xD}$ Bal./rpm G2.5/20000 Coolant AD For Solid Carbide

mm

订货型号-L		$\varnothing d1$	D1	D2	L1	L
HSK40A	SHR 3 - 60	19	3	9	9	60
	SHR 3 - 120					120
	SHR 4 - 60	20	4	10	12	60
	SHR 4 - 120					120
	SHR 5 - 60	21	5	11	15	60
	SHR 5 - 120					120
	SHR 6 - 80	22	6	12	25	80
	SHR 6 - 120					120
	SHR 8 - 80	24	8	14		80
	SHR 8 - 120					120
	SHR10 - 80	26	10	16	32	80
	SHR10 - 120					120
	SHR12 - 90	28	12	18	38	90
	SHR12 - 120					120
HSK50A	SHR 4 - 60	18.6	4	10	12	60
	SHR 5 - 60	19.6	5	11	15	
	SHR 6 - 60	19.6	6	12	25	
	SHR 8 - 80	21.6	8	14	25	80
	SHR 8 - 120					120
	SHR10 - 80	23.6	10	16	32	80
	SHR10 - 120					120
	SHR12 - 85	25.6	12	18	38	85
	SHR12 - 120					120
	SHR14 - 90	27.6	14	20		40
	SHR14 - 120				120	
	SHR16 - 90	29.6	16	22	40	90
	SHR16 - 120					120
	SHR18 - 95	31.6	18	24	42	95
	SHR18 - 120					120
	SHR20 - 100	31.6	20	26	44	100
SHR20 - 120	120					

切削工具SHANK \varnothing 区分	$\varnothing 3 - 6$	$\varnothing 6.1 - 10$	$\varnothing 10.1 - 14$	$\varnothing 14.1 - 18$	$\varnothing 18.1 - 24$	$\varnothing 24.1 - 30$	$\varnothing 30.1 - 40$
h6	0 - 8 μm	0 - 9 μm	0 - 11 μm	0 - 11 μm	0 - 13 μm	0 - 13 μm	0 - 16 μm

SHR热缩刀柄-HSK柄

mm

订货型号-L		Ød1	D1	D2	L1	L
HSK63A	SHR 3 - 80	17.1	3	9	9	80
	SHR 4 - 80	18.1	4	10	12	80
	SHR 5 - 80	19.1	5	11	15	80
	SHR 6 - 80	20.1	6	12	25	80
	SHR 6 - 120					120
	SHR 8 - 80	22.1	8	14		80
	SHR 8 - 120					120
	SHR10 - 85	24.1	10	16	32	85
	SHR10 - 120					120
	SHR12 - 90	26.1	12	18	38	90
	SHR12 - 120					120
	SHR14 - 90					90
	SHR14 - 120	28.1	14	20		120
	SHR16 - 95					95
	SHR16 - 120	30.1	16	22		40
	SHR18 - 95				95	
	SHR18 - 120	32.1	18	24	42	120
	SHR20 - 100					100
	SHR20 - 120	34.1	20	26	44	120
	SHR25 - 115					115
SHR25 - 130	39.1	25	31	50	130	
SHR32 - 120					120	
SHR32 - 130					130	

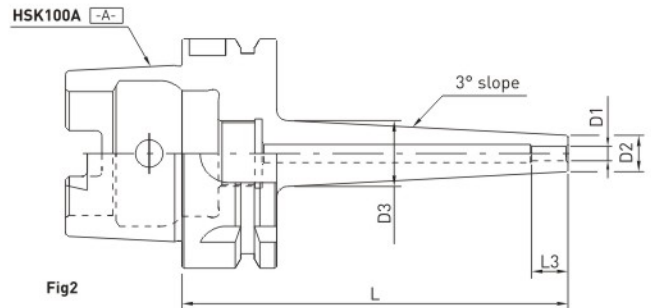
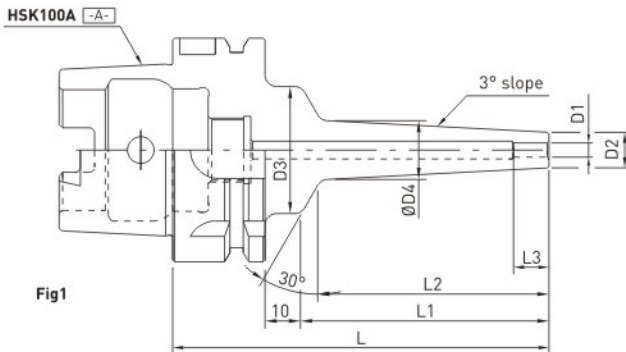

mm

订货型号-L		D1	D2	D3	D4	L1	L2	L3	L	TYPE
HSK100A	SHR 6 - 85	6	12	50	24.8	91	83.84	25	80	Fig1
	SHR 8 - 85	8	14						85	
	SHR10 - 90	10	16						90	
	SHR12 - 95	12	18					38	95	
	SHR14 - 95	14	20						95	
	SHR16 - 100	16	22					40	100	
	SHR18 - 100	18	24	-	42	100	Fig2			
	SHR20 - 105	20	26	-	44	105				
	SHR25 - 115	25	31	-	50	115				
	SHR32 - 120	32	38	-		120				

切削工具SHANK Ø 区分	Ø3-6	Ø6.1-10	Ø10.1-14	Ø14.1-18	Ø18.1-24	Ø24.1-30	Ø30.1-40
h6	0-8um	0-9um	0-11um	0-11um	0-13um	0-13um	0-16um

SL側固式端銑刀柄-BT柄

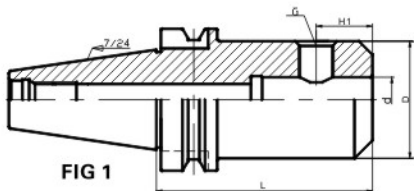

FIG 1

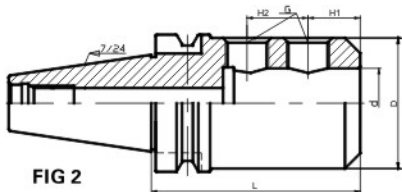
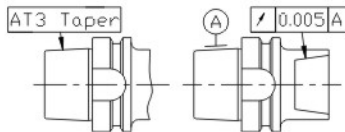

FIG 2



訂貨型號-L	圖號 FIG	ød	øD	H1	H2	G	
BT30-SL20-75	1	20	45	25	—	M16 x 1.5	
-SL25-90	2	25	61	24	25	M18 x 2.0	
BT40-SL08-75	1	8	28	18	—	M8 x 1.0	
-SL10-75		10	35	20		M10 x 1.0	
-SL12-75		12	42	22.5		M12 x 1.5	
-SL16-60		16	48	24		M14 x 1.5	
-75						M16 x 1.5	
-SL20-75		20	52	25		M16 x 1.5	
-SL25-90	2	25	61	24	25	M18 x 2.0	
-SL32-90		32	62	30	28	M20 x 2.0	
-SL40-100		40	64	30	32	M16 x 1.5	
BT50-SL08-75	1	8	28	18	—	M8 x 1.0	
-SL10-75		10	35	20		M10 x 1.0	
-SL12-75		12	42	22.5		M12 x 1.5	
-SL16-90		16	48	24		M14 x 1.5	
-SL20-90						M16 x 1.5	
-105		20	52	25		M16 x 1.5	
-150	2	25	65	24	25	M18 x 2.0	
-200						28	M20 x 2.0
-SL32-105							
-150	2	40	80	30	32	M20 x 2.0	
-200							
-300							
-SL40-120	2	42	80	30	32	M24 x 2.0	
-SL42-120							
-SL50-120							
-SL50.8-120							

SL側固式端銑刀柄-SK柄

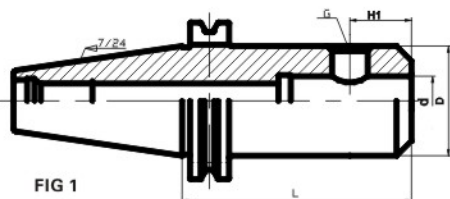

FIG 1

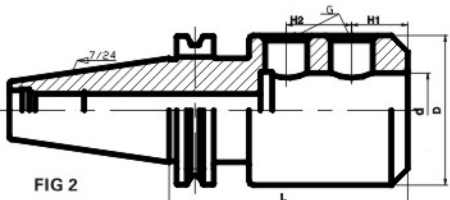

FIG 2

訂貨型號-L	圖號 FIG	ød	øD	H1	H2	G			
SK40-SL06-50	1	6	25	18	—	M6 x 0.75			
-SL08-50		8	28	18		M8 x 1.0			
-100						M10 x 1.0			
-130		10	35	20		M12 x 1.5			
-SL10-50						12	42	22.5	M14 x 1.5
-SL12-50									M16 x 1.5
-100		16	44.45	24		25	M18 x 2.0		
-SL16-60	20				52		25	M20 x 2.0	
-SL20-70	2	25	63.55	24	25	M18 x 2.0			
-130		32	64	24	28	M20 x 2.0			
-SL25-100	1	8	28	18	—	M8 x 1.0			
-SL32-100		10	35	20		M10 x 1.0			
SK50-SL08-63						12	42	22.5	M12 x 1.5
-SL10-63		16	50	24					M14 x 1.5
-SL12-63						20	52	25	M16 x 1.5
-SL16-63		25	65	24					25
-SL20-63	2	32	70	30	32	M20 x 2.0			
-SL25-80									
-SL32-100									
-SL40-120	2	40	80	30	32	M24 x 2.0			
-SL42-120									
-SL50-120	2	50	95	35	35	M24 x 2.0			

SL側固式端銑刀柄-CAT柄

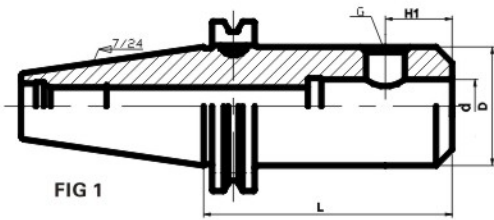

FIG 1

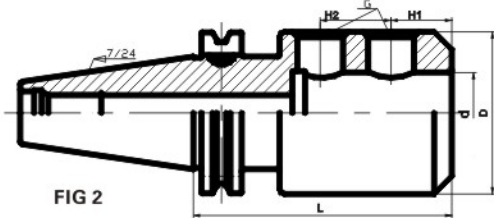

FIG 2

訂貨型號-L	圖號 FIG	ød	øD	H1	H2	G
CAT40-SL08-2.50"	1	8	28	18	—	M8 × 1.0
-SL10-2.50"		10	35	20		M10 × 1.0
-SL12-2.62"		12	42	22.5		M12 × 1.5
-SL16-2.75"		16	48	24		M14 × 1.5
-SL20-3.50"		20	52	25		M16 × 1.5
-SL25-4.00"	2	25	62	24	25	M18 × 2.0
-SL32-4.00"		32	64	24	28	M20 × 2.0
CAT50-SL08-2.50"	1	8	28	18	—	M8 × 1.0
-SL10-2.50"		10	35	20		M10 × 1.0
-SL12-2.62"		12	42	22.5		M12 × 1.5
-SL16-2.75"		16	48	24		M14 × 1.5
-SL20-3.50"		20	52	25		M16 × 1.5
-SL25-4.00"	2	25	65	24	25	M18 × 2.0
-SL32-4.00"		32	70	24	28	M20 × 2.0
-SL40-4.70"		40	90	30	32	M20 × 2.0

SL側固式端銑刀柄-HSK柄

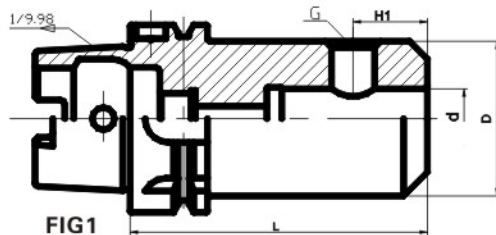

FIG 1

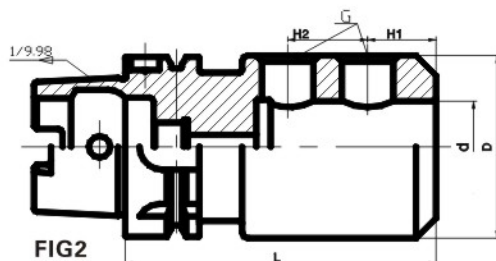

FIG 2

訂貨型號-L	圖號 FIG	ød	øD	H1	H2	G	
HSK-A63-SL06-80	1	6	25	18	—	M6 × 0.75	
-SL08-80		8	28	18		M8 × 1.0	
-SL10-80		10	35	20		M10 × 1.0	
-SL12-90		12	42	22.5		M12 × 1.5	
SL14-90		14	45	23		24	M14 × 1.5
-SL16-100		16	48	24			
-SL18-100		18	50	24		25	M16 × 1.5
-SL20-100		20	52	25			
-SL25-110	2	25	62	24	25	M18 × 2.0	
-SL32-110		32	63	24	28	M20 × 2.0	
HSK-A100-SL10-80	1	10	35	20	—	M10 × 1.0	
-SL12-90		12	42	22.5		M12 × 1.5	
-SL16-100		16	48	24		M14 × 1.5	
-SL20-100		20	52	25		M16 × 1.5	
-SL25-110	2	25	64	24	25	M18 × 2.0	
-SL32-110		32	72	24	28	M20 × 2.0	
-SL40-120		40	80	30	32		

標準平衡等級: 16000rpm/G6.3。
Standard balance: 16000rpm/G6.3

★ 以上規格均不含冷卻水管，如有需要請另外訂購。

MTA有扁尾莫氏锥孔刀柄-BT柄

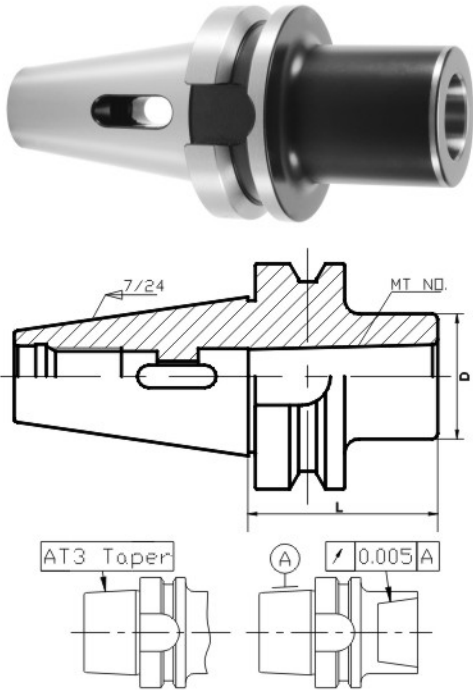

訂貨型號-L	莫氏錐號 MT No .	øD
BT30-MTA1-45	1	25
-MTA2-60	2	35
-MTA3-80	3	40
BT40-MTA1-45	1	25
-120		
-MTA2-60	2	35
-120		
-MTA3-75	3	40
-135		
-MTA4-90	4	50
BT50-MTA1-45	1	25
-120		
-MTA2-45	2	35
-135		
-MTA3-45	3	40
-150		
-MTA4-75	4	50
-180		
-MTA5-105	5	65
-210	5	65
-MTA6-275	6	85

MTA有扁尾莫氏锥孔刀柄-SK柄

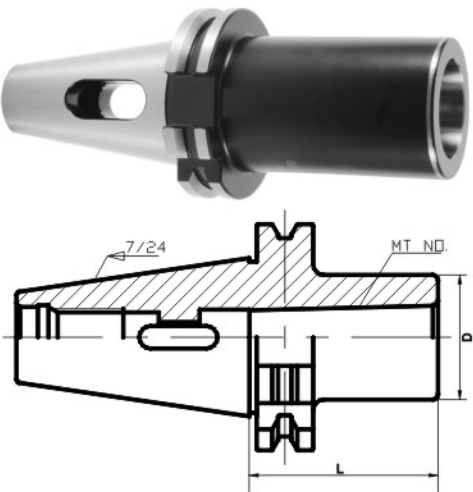

訂貨型號-L	莫氏錐號 MT No .	øD
SK40-MTA1-45	1	25
-120		
-MTA2-60	2	35
-120		
-MTA3-75	3	40
-135		
-MTA4-90	4	45
SK50-MTA1-45	1	25
-120		
-MTA2-45	2	35
-135		
-MTA3-45	3	42
-150		
-MTA4-75	4	50
-180		
-MTA5-105	5	65
-190		

MTA有扁尾莫氏锥孔刀柄-DIN2080柄

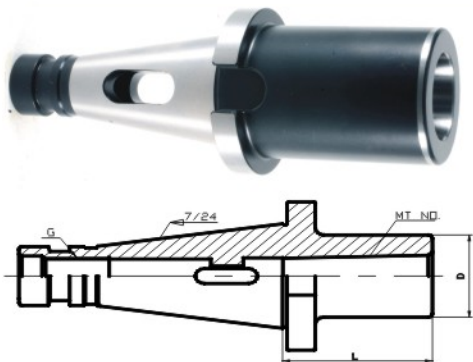

訂貨型號-L	莫氏錐號 MT NO .	øD	G	øD
DIN2080-40-MTA1-45	1	25	M16x2.0	0.6
-MTA2-45	2	35	M16 x 2.0	0.7
-MTA3-75	3	42		1.1
DIN2080-50-MTA2-45	2	35		M24 x 3.0
-MTA3-45	3	42	2.7	
-MTA4-75	4	50	3.0	

MTA有扁尾莫氏锥孔刀柄-NT柄

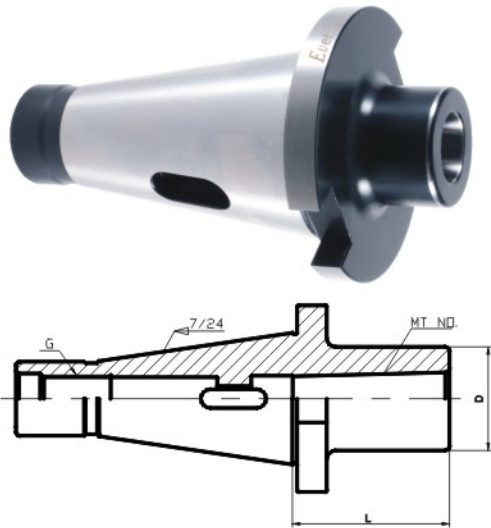

訂貨型號-L	莫氏錐號 MT NO .	∅D	G
NT50-MTA1-45	1	25	1 " -8UNC
-120			
-MTA2-45	2	35	
-135			
-MTA3-45	3	42	
-150			
-MTA4-75	4	50	
-190			

MTA有扁尾莫氏锥孔刀柄-CAT柄

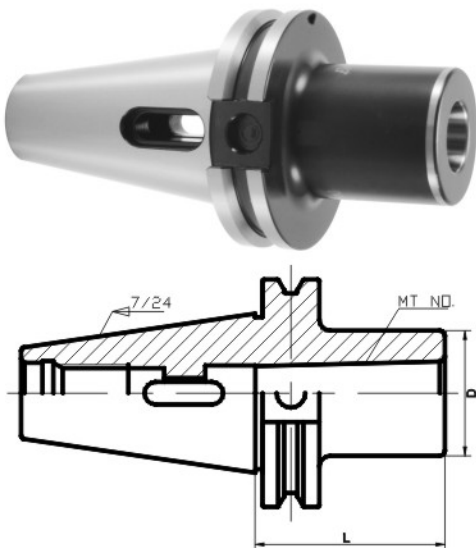

訂貨型號-L	莫氏錐號 MT NO .	∅D
CAT40-MTA1-45	1	25
-120		
-MTA2-60	2	35
-120		
-MTA3-75	3	40.5
-135		
-MTA4-90	4	44.5
-135		
CAT50-MTA1-45	1	25
-120		
-MTA2-45	2	32
-135		
-MTA3-45	3	40
-150		
-MTA4-75	4	50
-180		
-MTA5-105	5	65

MTA有扁尾莫氏锥孔刀柄-HSK柄

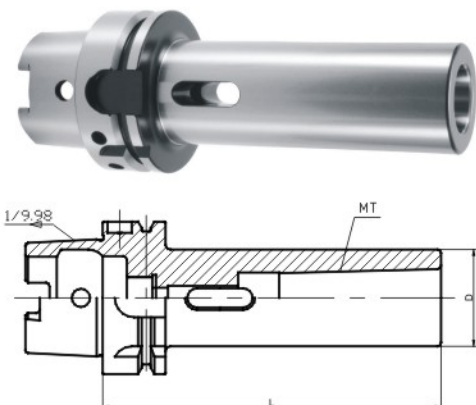

訂貨型號-L	莫氏錐號 MT NO .	∅D
HSK-A63-MTA1-100	1	25
-MTA2-120	2	35
-MTA3-140	3	40
-MTA4-160	4	50
HSK-A100-MTA1-110	1	25
-MTA2-120	2	35
-MTA3-150	3	40
-MTA4-170	4	50
-MTA5-200	5	65

★ 以上規格均不含冷却水管，如有需要請另外訂購。

MTB无扁尾莫氏锥孔刀柄-BT柄

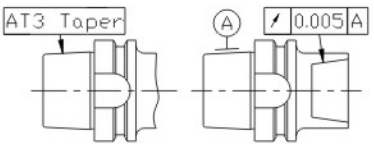
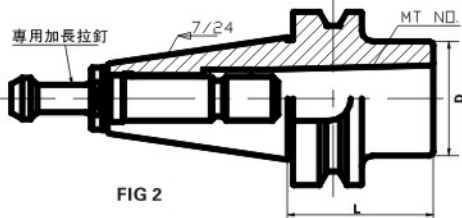
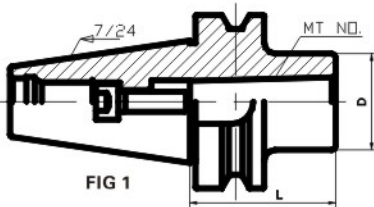

订货型号-L	图号 FIG	莫氏锥号 MT NO.	ØD	
BT30-MTB2-60※	2	2	35	
BT40-MTB1-45	1	1	25	
-MTB2-60		2	35	
-MTB3-75		3	40	
-MTB4-90※	2	4	50	
BT50-MTB1-45	1	1	25	
-120		2	35	
-MTB2-45			3	40
-135		4		50
-MTB3-60				50
-150		50		
-MTB4-75		65		
-150	1	5	65	
-MTB5-120				

★带“※”规格附带MTB专用拉钉。

MTB无扁尾莫氏锥孔刀柄-SK柄

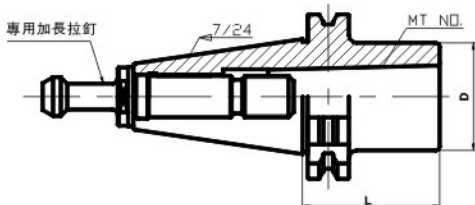
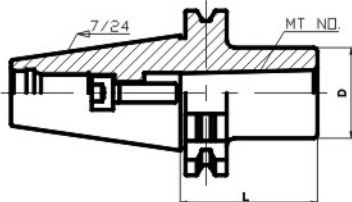

订货型号-L	图号 FIG	莫氏锥号 MT NO.	ØD	
SK40-MTB2-50	1	2	35	
-MTB3-75		3	38	
-MTB4-90※		2	4	45
SK50-MTB1-45	1	1	25	
-MTB2-45		2	35	
-135			3	42
-MTB3-60		4		50
-150				50
-MTB4-75		65		
-150		1	5	65
-MTB5-120				

★带“※”规格附带MTB专用拉钉。

FMA面铣刀柄-BT柄

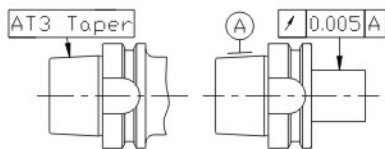
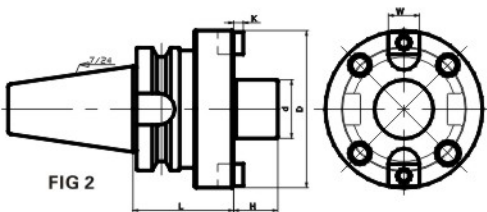
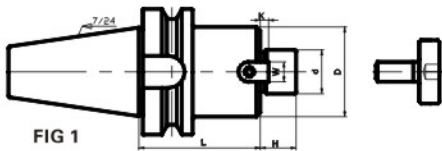

面铣刀柄端面經特殊研磨，刀盤裝上後能與刀柄緊密貼合，使刀盤能穩固地進行切削，達到最佳的銑削效果。

訂貨型號-L	圖號 FIG	ød(h6)	øD	H	K	W
BT30-FMA25.4-45	1	25.4	50	20	5	9.5
-FMA38.1-60		38.1	80	25	9	15.9
BT40-FMA25.4-45	1	25.4	50	20	5	9.5
-60						
-105						
-150						
-200						
-250*						
-FMA31.75-45						
-60						
-90						
-FMA38.1-60	1	38.1	80	25	9	15.9
BT50-FMA25.4-45	1	25.4	50	20	5	9.5
-90						
-105						
-150						
-200						
-250*						
-FMA31.75-45						
-75						
-105						
-150						
-200	1	38.1	80	25	9	15.9
-FMA38.1-45						
-75						
-FMA50.8-45	1	50.8	100	28	12	15.9
-FMA47.625-75						

注：帶“*”規格為加長型非標產品，如有需要請致電本司諮詢。

FMA面铣刀柄-SK柄

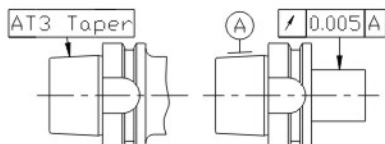
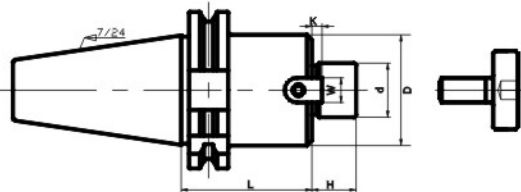

訂貨型號-L	ød(h6)	øD	H	K	W
SK40-FMA25.4-60	25.4	50	20	5	9.5
-90					
-FMA31.75-60	31.75	60	22	7	12.7
-90					
-FMA38.1-60	38.1	80	25	9	15.9
-90					
SK50-FMA25.4-60	25.4	50	20	5	9.5
-100					
-FMA31.75-60	31.75	60	22	7	12.7
-100					
-FMA38.1-60	38.1	80	25	9	15.9
-100					
-FMA50.8-60	50.8	100	28	12	
-100					

FMA面铣刀柄-CAT柄

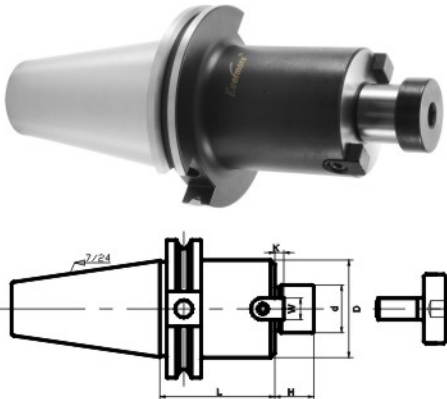

訂貨型號-L	∅d(h6)	∅D	H	K	W
CAT40-FMA25.4-2.0"	25.4	50	20	5	9.5
-FMA31.75-2.25"	31.75	60	22	7	12.7
-FMA38.1-2.4"	38.1	80	25	9	15.9
CAT50-FMA25.4-2.0"	25.4	50	20	5	9.5
-FMA31.75-1.5"	31.75	60	22	7	12.7
-FMA38.1-2.4"	38.1	80	25	9	15.9
-FMA50.8-2.4"	50.8	100	28	12	

FMA面铣刀柄-2080柄

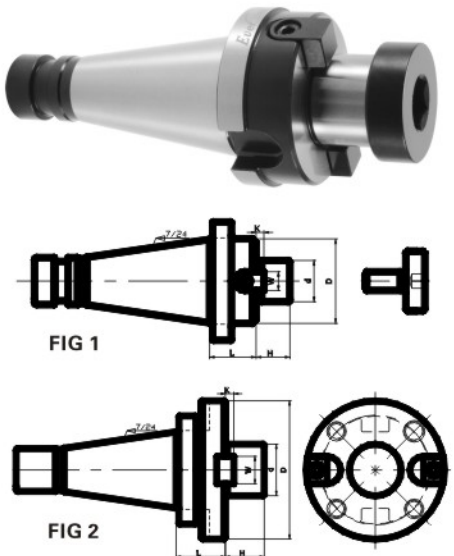

訂貨型號-L	圖號 FIG	∅d(h6)	∅D	H	K	W
DIN2080-30-FMA25.4-20	1	25.4	50	20	5	9.5
-FMA31.75-25		31.75	60	22	7	12.7
-FMA38.1-30		38.1	80	25	9	15.9
DIN2080-40-FMA25.4-25	1	25.4	50	20	5	9.5
-FMA31.75-25		31.75	60	22	7	12.7
-FMA38.1-30		38.1	80	25	9	15.9
-FMA50.8-35		50.8	100	28	12	
DIN2080-50-FMA25.4-35	1	25.4	50	20	5	9.5
-FMA31.75-35		31.75	60	22	7	12.7
-FMA38.1-35		38.1	80	25	9	15.9
-FMA50.8-35		50.8	100	28	12	
-FMA47.625-45	2	47.625	128	32	12.5	25.4

FMA面铣刀柄-NT柄

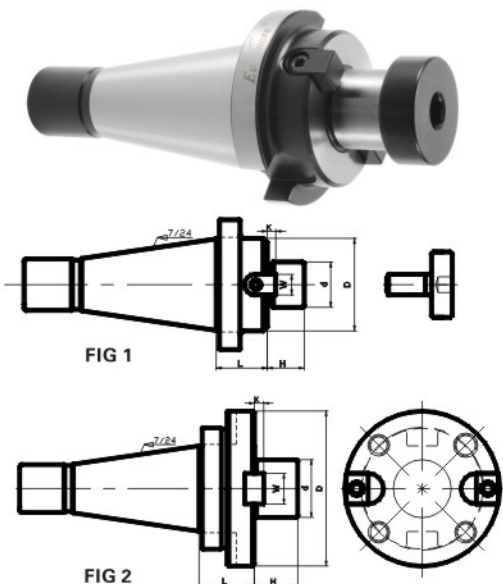

訂貨型號-L	圖號 FIG	∅d(h6)	∅D	H	K	W
NT30-FMA25.4-20	1	25.4	50	20	5	9.5
-FMA31.75-25		31.75	60	22	7	12.7
-FMA38.1-30		38.1	80	25	9	15.9
NT40-FMA25.4-25	1	25.4	50	20	5	9.5
-FMA31.75-25		31.75	60	22	7	12.7
-FMA38.1-30		38.1	80	25	9	15.9
-FMA50.8-35		50.8	100	28	12	
NT50-FMA25.4-35	1	25.4	50	20	5	9.5
-FMA31.75-35		31.75	60	22	7	12.7
-FMA38.1-35		38.1	80	25	9	15.9
-FMA50.8-35		50.8	100	28	12	
-FMA47.625-45	2	47.625	128	32	12.5	25.4

FMA面铣刀柄-HSK柄

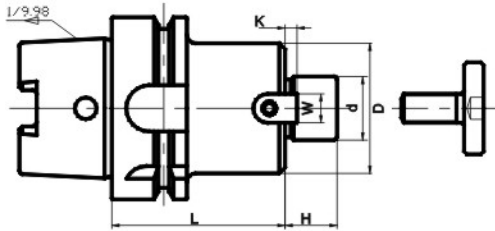

訂貨型號-L	ød(h6)	øD	H	K	W
HSK-A63-FMA25.4-60	25.4	50	20	5	9.5
-120					
-FMA31.75-60	31.75	60	22	7	12.7
-120					
-FMA38.1-60	38.1	80	25	9	15.9
-120					
HSK-A100-FMA25.4-60	25.4	50	20	5	9.5
-120					
-FMA31.75-60	31.75	60	22	7	12.7
-120					
-FMA38.1-60	38.1	80	25	9	15.9
-120					
-FMA50.8-60	50.8	100	28	12	15.9
-120					

標準平衡等級：16000rpm/G6.3。

FMB(C)面铣刀柄-BT柄

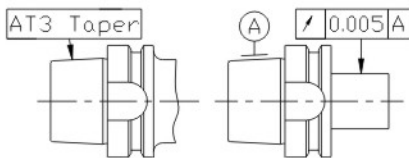
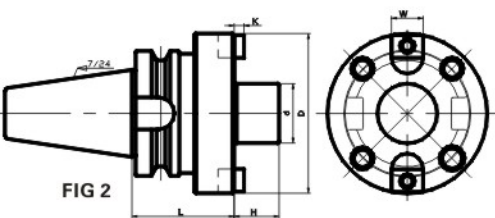
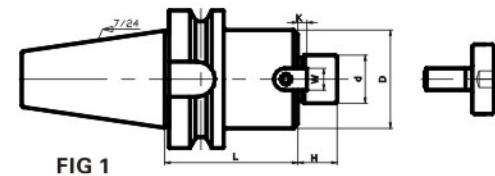

注：B型使用大頭鎖緊螺絲，C型使用小頭鎖緊螺絲。

訂貨型號-L	圖號 FIG	ød (h6)	øD	H	K	W
BT30-FMB (C) 22-45	1	22	48	18	5	10
-100						
-FMB (C) 27-60						
-FMB (C) 32-60	1	22	48	18	5	10
-60						
-90						
-105	1	27	60	20	6	12
-150						
-200						
-FMB (C) 27-45	1	27	60	20	6	12
-60						
-105						
-FMB (C) 32-45	1	32	72	22	7	14
-60						
-FMB (C) 40-70						
-FMB (C) 40F-60	2	40	80	25	8	16
-FMB (C) 40M-60			110			
			89.3			
BT50-FMB (C) 22-60	1	22	48	18	5	10
-105						
-150						
-200						
-250*						
-300*						
-350*						
BT50-FMB (C) 22-200C	1	22	58	18	5	10
-250C*						
-300C*						
-350C*						
BT50--FMB (C) 27-45	1	27	60	20	6	12
-90						
-105						
-FMB (C) 32-45	1	32	72	22	7	14
-75						
-105						
-150						

FMB(C)面铣刀柄-BT柄



訂貨型號-L	圖號 FIG	∅d (h6)	∅D	H	K	W
BT50--FMB (C) 40-45	1	40	80	25	8	16
-70						
-105						
-FMB (C) 40F-75	2	40	110	25	8	16
-FMB (C) 40M-75			89.3			
-FMB (C) 60F-75						
-FMB (C) 60M-75	60	140	25	12.5	25.4	
		129.1				

注：B型使用大頭鎖緊螺絲，C型使用小頭鎖緊螺絲。

FMB(C)面铣刀柄-SK柄

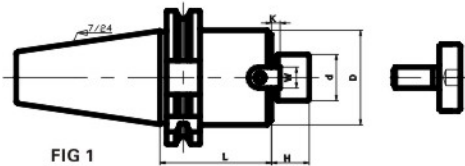

FIG 1

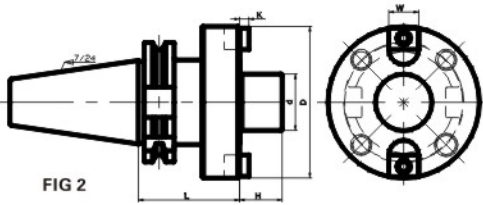
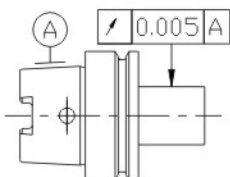
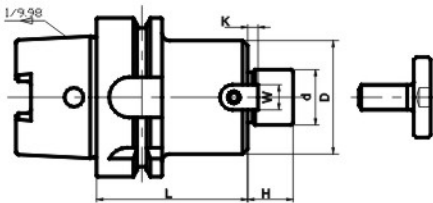

FIG 2

訂貨型號-L	圖號 FIG	∅d(h6)	∅D	H	K	W					
SK40-FMB (C) 22-60	1	22	48	18	5	10					
-105											
-200											
-FMB (C) 27-60		27	60	20	6	12					
-120											
-FMB (C) 32-45											
-60	2	40	80	25	8	16					
-FMB (C) 40F-60			110								
-FMB (C) 40M-60			89.3								
SK50-FMB (C) 22-60	1	22	48	18	5	10					
-FMB (C) 27-60							27	60	20	6	12
-FMB (C) 32-60											
-FMB (C) 40-60	2	40	80	25	8	16					
-FMB (C) 40F-75			110								
-FMB (C) 40M-75			89.3								
-FMB (C) 60F-75	60	140	25	12.5	25.4						
-FMB (C) 60M-75						129.1					

注：B型使用大頭鎖緊螺絲，C型使用小頭鎖緊螺絲。

FMB(C)面铣刀柄-HSK柄



訂貨型號-L	∅d(h6)	∅D	H	K	W
HSK-A63-FMB (C) 22-50	22	48	18	5	10
-120					
-FMB (C) 27-60					
-120	27	60	20	6	12
-FMB (C) 32-60					
-120					
-FMB (C) 40-60	32	72	22	7	14
-120					
-FMB (C) 40-60					
-120	40	80	25	8	16
-FMB (C) 22-50					
-120					
HSK-A100-FMB (C) 22-50	22	48	18	5	10
-120					
-FMB (C) 27-60					
-120	27	60	20	6	12
-FMB (C) 32-60					
-120					
-FMB (C) 40-60	32	72	22	7	14
-120					
-FMB (C) 40-60					
-120	40	80	25	8	16
-FMB (C) 22-50					
-120					

標準平衡等級：16000rpm/G6.3。如有特別要求，平衡等級可達：24000rpm/G2.5

注：B型使用大頭鎖緊螺絲，C型使用小頭鎖緊螺絲。

WER攻牙刀柄-BT柄

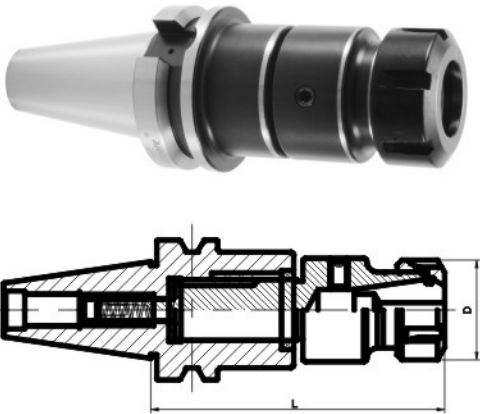

訂貨型號-L	ØD	筒夾型號
BT30-WER16-90	30	ER16
-WER20-100	34	ER20
BT40-WER16-90	30	ER16
-WER20-100	34	ER20
-WER25-110	42	ER25
-WER32-120	50	ER32
BT50-WER16-90	30	ER16
-WER20-100	34	ER20
-WER25-110	42	ER25
-WER32-120	50	ER32
-200	50	ER32

★ 以上規格均不含扳手、筒夾及拉釘，如有需要請另外訂購。

WER攻牙刀柄-SK柄

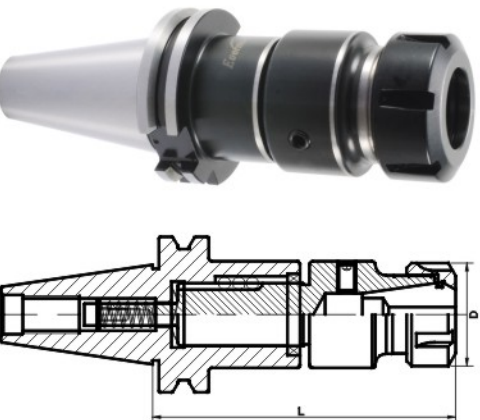

訂貨型號-L	ØD	筒夾型號
SK40-WER16-70	30	ER16
-WER20-90	34	ER20
-WER25-100	42	ER25
-WER32-110	50	ER32
SK50-WER16-90	30	ER16
-WER20-90	34	ER20
-WER25-90	42	ER25
-WER32-100	50	ER32

WER攻牙刀柄-CAT柄

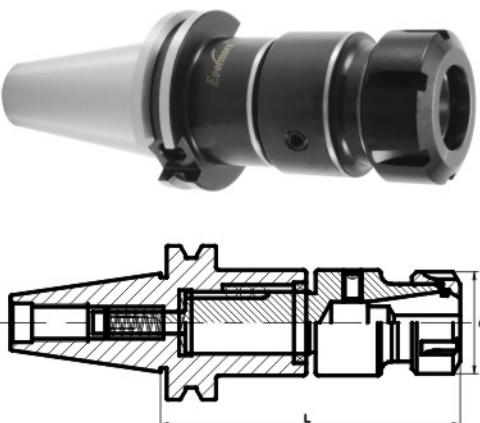

訂貨型號-L	ØD	筒夾型號
CAT40-WER16- 70	30	ER16
-WER20- 90	34	ER20
-WER25-100	42	ER25
-WER32-110	50	ER32
CAT50-WER16- 90	30	ER16
-WER20- 90	34	ER20
-WER25- 90	42	ER25
-WER32-100	50	ER32

★ 以上規格均不含扳手、筒夾及拉釘，如有需要請另外訂購。

SCA侧铣刀刀柄-BT柄

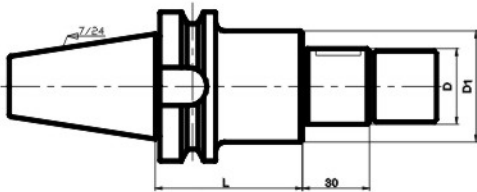

▲更換不同厚度的墊片可夾持不同厚度的銑刀。

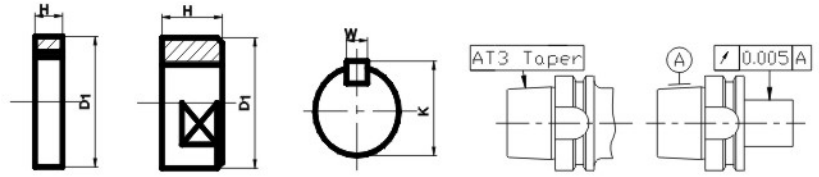

訂貨型號-L	∅D(h6)	∅D1	H	K	W	
BT40-SCA16-90	16	26	5/10/20	17.2	4	
BT40-SCA22-75	22	34		23.6	6	
-120						
-SCA27-75	27	40		29	7	
-120						
-SCA32-90	32	46		34	8	
-SCA40-90	40	55	42.5	10		
-SCA25.4-75	25.4	40	5/10/20	27.78	6.35	
-120						
BT50-SCA22-90	22	34		23.6	6	
-135	27	40		29	7	
-SCA27-90						
-135						
-SCA32-135	32	46	34	8		
-SCA25.4-90	25.4	40	27.78	6.35		
-135						

WF快換式攻牙刀柄-BT柄

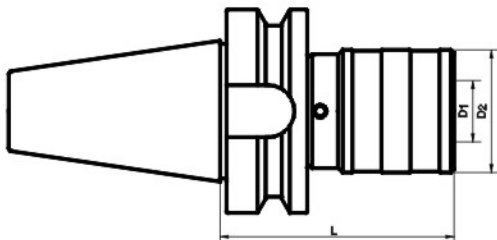

訂貨型號-L	攻絲範圍	∅D1	∅D2	伸縮長度		可使用筒夾型號
				壓縮	伸長	
BT30-WF12	M3-M12	19	39	7.5	7.5	TC312 TC312L TC312R
-WF20	M8-M20	31	55	12.5	12.5	TC820 TC820L TC820R
BT40-WF12	M3-M12	19	39	7.5	7.5	TC312 TC312L TC312R
-WF20	M8-M20	31	55	12.5	12.5	TC820 TC820L TC820R
-WF33	M14-M33	48	78	20.0	20.0	TC1433
BT50-WF12	M3-M12	19	39	7.5	7.5	TC312 TC312L TC312R
-WF20	M8-M20	31	55	12.5	12.5	TC820 TC820L TC820R
-WF33	M14-M33	48	78	20.0	20.0	TC1433
HSK-A63-WF12	M3-M12	19	39	7.5	7.5	TC312 TC312L TC312R
-WF20	M8-M20	31	55	12.5	12.5	TC820 TC820L TC820R
-WF33	M14-M33	48	78	20.0	20.0	TC1433
HSK100A-WF12	M03-M12	19	36	7.5	7.5	TC312
-WF20	M08-M20	31	53	12.5	12.5	TC820
-WF33	M14-M33	48	78	20.0	20.0	TC1433

※有套裝產品可供選擇，可根據需要單支或整套訂購。

※如需整套訂購，請在訂購時說明所需筒夾的型號。

整套 WHOLE SET						
BT30-WF12T	M3-M12	19	39	7.5	7.5	TC312 TC312L TC312R
-WF20T	M8-M20	31	55	12.5	12.5	TC820 TC820L TC820R
BT40-WF12T	M3-M12	19	39	7.5	7.5	TC312 TC312L TC312R
-WF20T	M8-M20	31	55	12.5	12.5	TC820 TC820L TC820R
BT50-WF12T	M3-M12	19	39	7.5	7.5	TC312 TC312L TC312R
-WF20T	M8-M20	31	55	12.5	12.5	TC820 TC820L TC820R
HSK-A63-WF12T	M3-M12	19	39	7.5	7.5	TC312 TC312L TC312R
-WF20T	M8-M20	31	55	12.5	12.5	TC820 TC820L TC820R

TC攻丝刀柄-BT柄



- 由于按照轴方向浮动，可有效地吸收主轴旋转和偏移，防止刀柄破损。
- 攻丝套筒以轻触的方式就可以迅速简便的更换

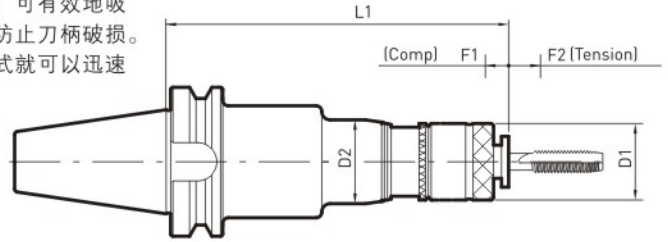

Taper AT3 mm

订货型号-L	TAPPING RANGE			D1	D2	L1	F1	F2	WEIGHT (Kg)	COLLET	
	M	U	P								
BT30	TC0312 - 130	3-12	1/4 - 1/2	1/8	32	45	130	6.5	12	1.5	SES1
BT40	TC0312 - 135										
BT40	TC0822 - 160	8-22	5/16 - 7/8	1/8 - 1/2	50	62	160	14.5	13	2.6	SES2
BT50	TC0312 - 150	3-12	1/4 - 1/2	1/8	32	45	150	6.5	12	4.2	SES1
	TC0312 - 210										
	TC0822 - 175	8-22	5/16 - 7/8	1/8 - 1/2	50	62	175	14.5	13	5.4	SES2
	TC0822 - 225										
BT50	TC1638 - 240	16-38	5/8 - 1 3/8	1/4 - 1 1/8	72	88	240	20	20	7.8	SES3

SES攻丝套筒

mm

订货型号	TAPPING RANGE			D1	D2	L1	L2	CHUCK CODE
	M	U	P					
SES-1	3-12	1/4 - 1/2	1/8	19	32	25	21.5	TC0312
SES-2	8-25	5/16 - 7/8	1/8 - 1/2	31	50	33	35.5	TC0822
SES-3	16-38	5/8 - 1 3/8	1/4 - 1 1/8	48	72	45	55.5	TC1638

TAP COLLET 攻丝套筒选择方式

TAP COLLET 范围 (SES)	TAP SIZE					
	METRIC		UNC	SHANK		
				Ø	⊠	
SES1	M3		N05,6	4	3.2	
	M4	M4.5		5	4	
	M5	M5.5		5.5	4.5	
	M6		U 1/4	6		
			U 5/16	6.1	5	
	M8	M7		6.2		
	M10	M9	U 3/8	7	5.5	
		M11	U 7/16	8	6	
		M12		8.5	6.5	
	SES2			U 1/2	9	7
		M14	M15	U 9/16	10.5	8
				U 5/8	12	9
M16				12.5	10	
M17				13		
M18			U 3/4	14	11	
SES3	M20			15	12	
	M22		U 7/8	17	13	
	M24	M25		19	15	
	M27	M26	U 1	20		
		M28		21	17	
			U 1 1/8	22		
	M30			23	17	
	M32		U 1 1/4	24	19	
	M33			25		
	M35	M34	U 1 3/8	26	21	
M36	M38		28			

TAP COLLET 范围 (SES)	TAP SIZE					
	PT		PF		SHANK	
					Ø	⊠
SES1	S	1/8	1/8		8	6
	E	1/4	1/4		11	9
SES2	S	3/8	3/8		14	11
	2	1/2	1/2		18	14
SES3				5/8	19	15
		3/4	3/4		23	17
			7/8		24	19
		1	1		26	21
			1 1/8		28	

丝锥柄部尺寸是KS(JIS)标准。



- 内设扭矩保护装置，过负荷时自动空回转，防止螺纹的损坏。

- Ball Clamp形式作业时，无工具脱落现象，可一次性交换工具，夹持及脱附简便。

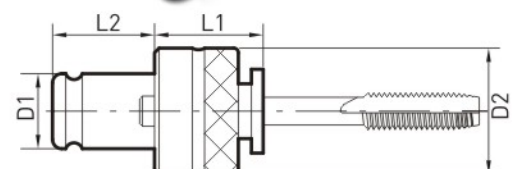

KPU钻夹头刀柄-BT柄

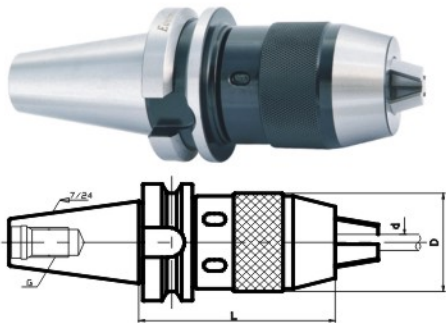

訂貨型號-L	ØD	夾持範圍Ød	G
BT30-KPU08-75	36	0.5-8	M12
-KPU13-91	50	0.5-13	
BT40-KPU08-80	36	0.5-8	M16
-KPU13-95	50	0.5-13	
-KPU16-113	57	3-16	
BT50-KPU13-105	50	0.5-13	M24
-KPU16-110	57	3-16	

KPU钻夹头刀柄-SK柄

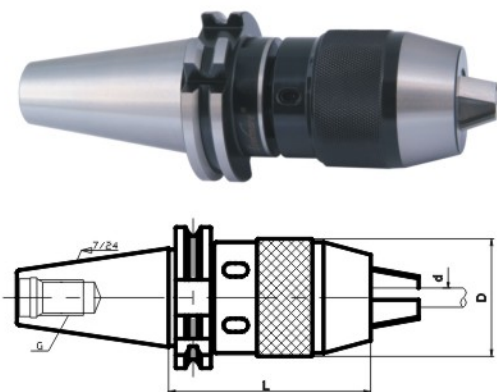

訂貨型號-L	ØD	夾持範圍Ød	G
SK40-KPU08-70	36	0.5-8	M16
-KPU13-82	50	0.5-13	
-KPU16-105	57	3-16	
SK50-KPU13-85	50	0.5-13	M24
-KPU16-90	57	3-16	

KPU钻夹头刀柄-CAT柄

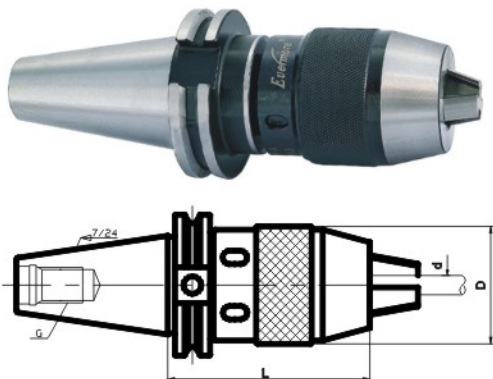

訂貨型號-L	ØD	夾持能力Ød	G
CAT40-KPU08-82	36	0.5-8	5/8" -11UNC
-KPU13-100	50	0.5-13	
-KPU16-125	57	3-16	
CAT50-KPU13-100	50	0.5-13	1" -8UNC
-KPU16-105	57	3-16	

KPU钻夹头刀柄-HSK柄

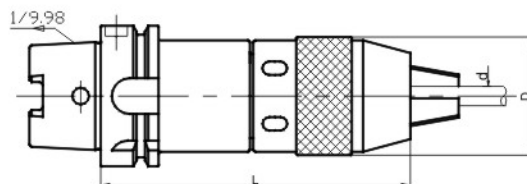

訂貨型號-L	ØD	夾持範圍Ød
HSK-A63-KPU13-135	45	0.5-13
HSK-A100-KPU13-140	45	0.5-13

KPU钻夹头刀柄-DIN2080柄

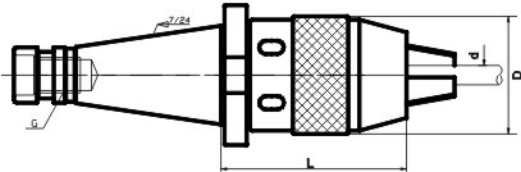

訂貨型號-L	ØD	夾持能力Ød	G (公制)
DIN2080-30-KPU08-70	36	0.5-8	M12
-KPU13-85.5	50	0.5-13	
DIN2080-40-KPU08-70	36	0.5-8	M16
-KPU13-85	50	0.5-13	
-KPU16-105	57	3-16	
DIN2080-50-KPU13-95	50	0.5-13	M24
-KPU16-100	57	3-16	

KPU钻夹头刀柄-NT柄

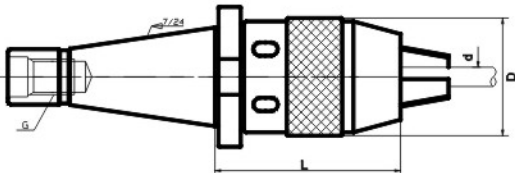

訂貨型號-L	ØD	夾持能力Ød	G (英制)
NT30-KPU08-70	36	0.5-8	1/2" -12UNC
-KPU13-85.5	50	0.5-13	
NT40-KPU08-70	36	0.5-8	5/8" -11UNC
-KPU13-85	50	0.5-13	
-KPU16-105	57	3-16	
NT50-KPU13-95	50	0.5-13	1" -8UNC
-KPU16-100	57	3-16	

B/JTA型锥度钻夹头刀柄-BT柄

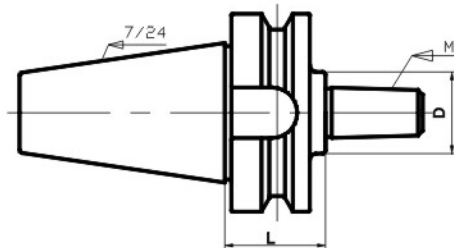

訂貨型號-L	錐號 M	Ø D
BT40-B16-35	B16	26
-JT6-45	JT6	
BT50-B16-45	B16	26
-105		

JTA型锥度钻夹头刀柄-DIN2080柄

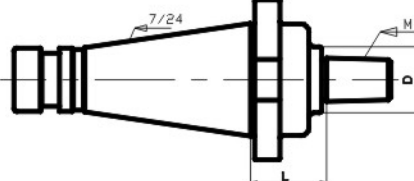

訂貨型號-L	錐號 M	Ø D
DIN2080-40-JT6	JT6	26
DIN2080-50-JT6	JT6	26

▲本系列刀柄需配合JTA錐孔鑽夾頭使用。

EM小铣头刀柄-BT柄

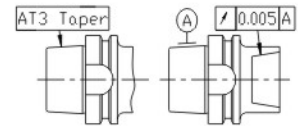
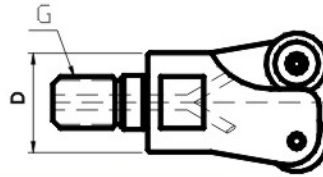
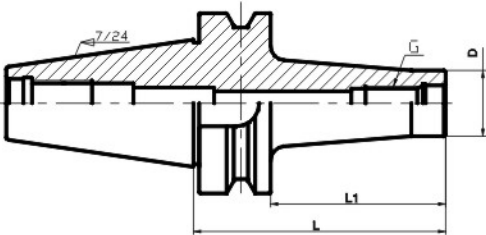

訂貨型號-L	L1	ØD	G
BT40-EM08-80	53	13.8	M8
-100	73		
-EM10-80	53	18.5	M10
-100	73		
-EM12-80	53	23	M12
-100	73		
-EM16-80	53	30	M16
-100	73		

訂貨型號-L	L1	ØD	G
BT50-EM08-100	62	13.8	M8
-150	112		
-EM10-100	62	18.5	M10
-150	112		
-EM12-100	62	23	M12
-150	112		
-EM16-100	62	30	M16
-150	112		

★ 以上規格均不含小銑頭，如有需要請另外訂購。

EM小铣头刀柄-SK柄

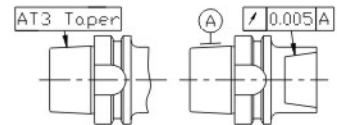
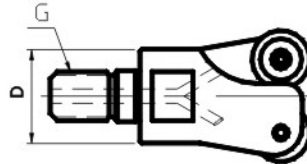
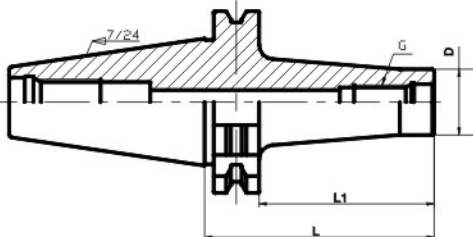

訂貨型號-L	L1	ØD	G
SK40-EM08-80	60.9	13.8	M8
-100	80.9		
-EM10-80	60.9	18.5	M10
-100	80.9		
-EM12-80	60.9	23	M12
-100	80.9		
-EM16-80	60.9	30	M16
-100	80.9		

訂貨型號-L	L1	ØD	G
SK50-EM08-100	80.9	13.8	M8
-150	130.9		
-EM10-100	80.9	18.5	M10
-150	130.9		
-EM12-100	80.9	23	M12
-150	130.9		
-EM16-100	80.9	30	M16
-150	130.9		

★ 以上規格均不含小銑頭，如有需要請另外訂購。

EM小铣头刀柄-HSK柄

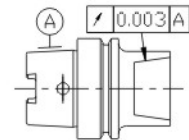
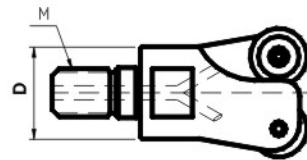
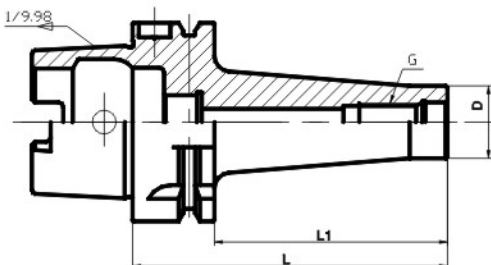

訂貨型號-L	L1	ØD	G
HSK-A63-EM08-100	74	13.8	M8
-150	124		
-EM10-100	74	18.5	M10
-150	124		
-EM12-100	74	23	M12
-150	124		
-EM16-100	74	30	M16
-150	124		

訂貨型號-L	L1	ØD	G
HSK-A100-EM08-100	71	13.8	M8
-150	121		
-EM10-100	71	18.5	M10
-150	121		
-EM12-100	71	23	M12
-150	121		
-EM16-100	71	30	M16
-150	121		

標準平衡等級：16000rpm/G6.3。如有特別要求，平衡等級可達：24000rpm/G2.5

★ 以上規格均不含小銑頭及冷却水管，如有需要請另外訂購。

油路側固式刀把

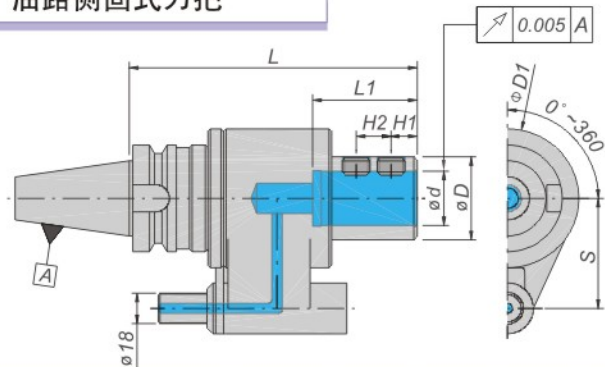

訂貨型號-L	ød	øD	øD1	L	L1	H1	H2	G	S
BT40-OSL16-150	16	49	82	150	48	25	-	M12*1.75P*1	65
-OSL20-150	20				50				
-OSL25-165	25				56				
-OSL32-165	32				60				
BT50-OSL16-165	16	49	98	165	48	25	-	M12*1.75P*1	80
-OSL20-165	20				50				
-OSL25-165	25				56				
-OSL32-165	32				60				
-OSL40-165	40	59	70	15	20	M16*2.00P*2			
						25	M14*2.00P*2		

OSL 套筒

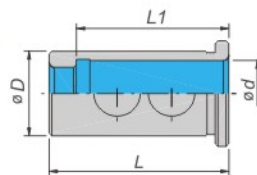

訂貨型號-L	ød	øD	L	L1
OSL25-160	16	25	60	48
-200	20		50	
OSL32-200	20	32	64	56
-250		25	56	
OSL40-250	32	40	74	60
-320		32	60	

止动块

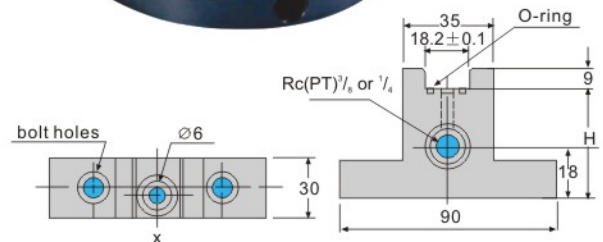

OHER 油路弹性筒夹刀把

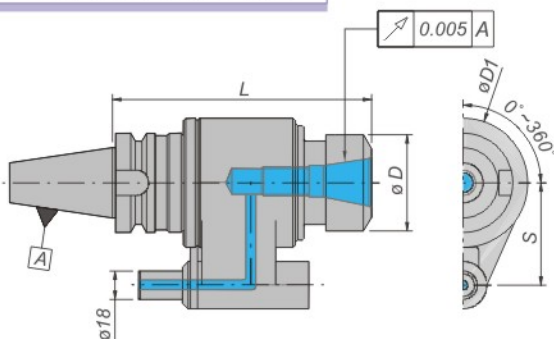

訂貨型號-L	øA Range 搪孔範圍	øD	øD1	L	S	彈性筒夾
BT40-OHER25-175	ø4 ~ ø16	42	82	175	65	EROH25
-OHER32-175	ø4 ~ ø20	50				EROH32
BT50-OHER25-180	ø4 ~ ø16	42	98	180	80	EROH25
-OHER32-180	ø4 ~ ø20	50				EROH32

角度头刀柄



▲本體與角度頭可360°自由回轉

MAX 3000RPM

▲內藏式筒夾設計，剛性强，幹涉小。

側面加工

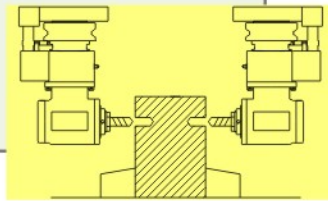

360度自由加工

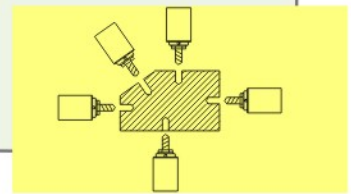

內面加工

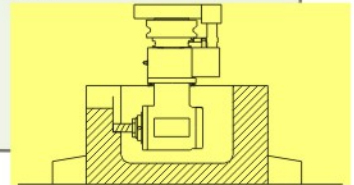

主要功能:
Main function



▲攻螺紋



▲中輕度銑削



▲鑽孔

高精度

▲EVERMORE角度頭殼體使用高精度的車銑中心經過精密的制造，以獲得高的尺寸精度、形狀精度和內外各輪廓及幾何要素的位置精度；由一批訓練有素的技术工人使用專用量具、夾具及高精度檢測設備進行測量和組裝。
▲EVERMORE角度頭采用高精度的螺旋齒輪和軸承以獲得更高的精度和剛性。

高精度機床 + 專業夾具 +

高級技工 + 精密量具 +

高精度配件

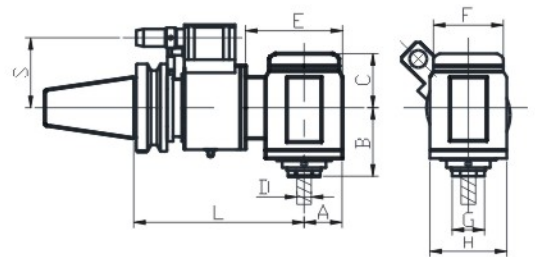
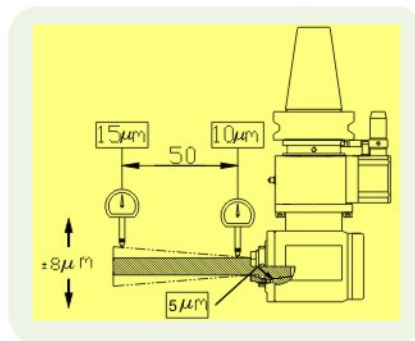

訂貨型號-L	∅D	S	L	A	B	C	E	F	∅G	H	重量
BT40-AHER32-150	2-20	60/65	150	44	78.2	63.8	89	80	36	88	7
-185			185				113				9
BT50-AHER32-175		80/85/110	175				103				13
-195			195				113				14
SK40-AHER32-174		60/65	174				113				8.8
SK50-AHER32-173		80/85/110	173								13

万向角度头

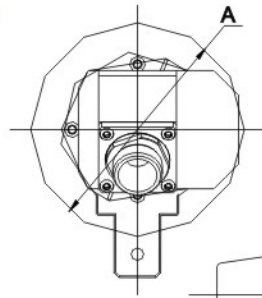

▲具備傳統角度頭的特點，本體與角度頭可360°自由回轉。
▲角度設定簡單，精度高；銑頭可在0 ~ ±90°間調整，調整角度的分度值為2°。

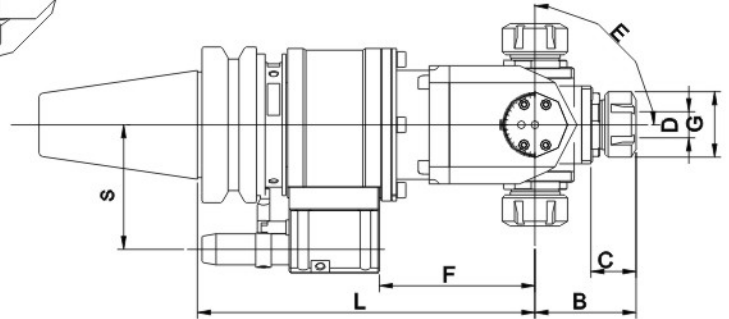

訂貨型號-L	ØD	S	L	A	B	C	E	F	ØG	重量Kg
BT40-AHER25-ANG182	2~16	60/65	182	138	65	29	±90°	80	42	9.2
BT50-AHER25-ANG200		80/85/110	200							13.6
SK40-AHER25-ANG176		60/65	176							9
SK50-AHER25-ANG178		80/85/110	178							12.6

主要功能:

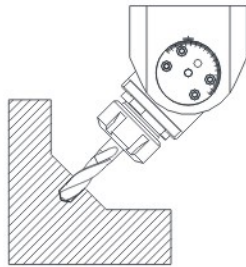

傾斜面加工

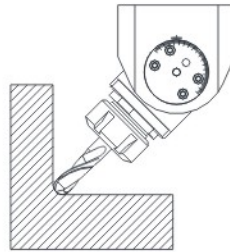

內型腔R角加工

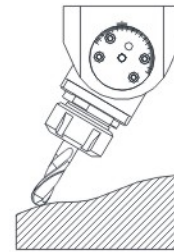

仿形加工

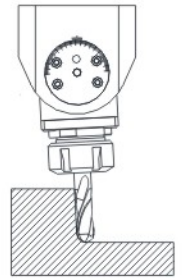

拔模角加工

FM型角度头

▲具備傳統角度頭的特點，本體與角度頭可360°自由回轉。
▲面銑刀專用角度頭，直接連接面銑刀加工快速穩定。
▲可自動換刀，批量生產必備工具。

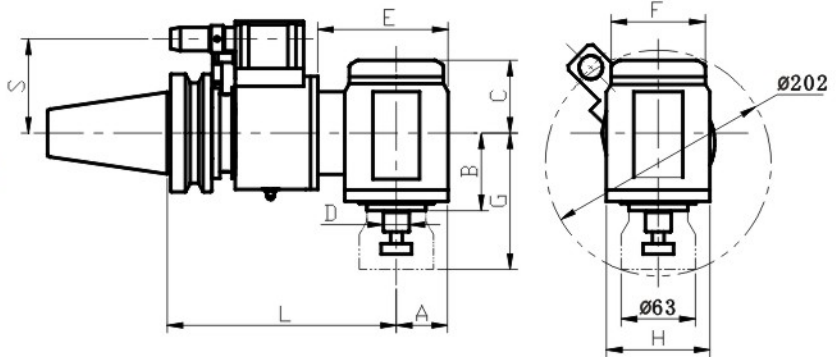

訂貨型號-L	ØD	S	L	A	B	C	E	F	G	H	重量Kg
BT50-AHFM22-195	Ø22	80/85/110	195	44	66	63.8	113	80	116	88	14kg
BT50-AHFM22-175			175								12.6kg

SHR热膨胀接长杆

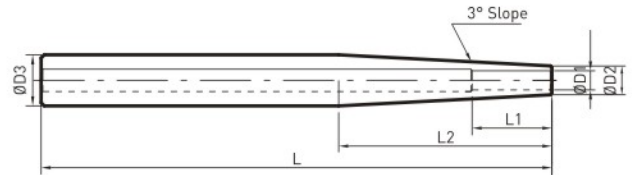

(EXTRA SLIM)

For Solid Carbide mm

订货型号-L		D1	D2	D3	L1	L2	L	Shank Tolerance
SR12	SHR3 - 160	3	6	12	9	52.2	160	h4
	SHR4 - 160	4	7		12	47.7		
	SHR5 - 160	5	8		15	38.2		
	SHR6 - 160	6	9		25	28.6		
SR16	SHR3 - 160	3	6	16	9	85.9		h6
	SHR4 - 160	4	7		12	85.9		
	SHR5 - 160	5	8		15	76.3		
	SHR6 - 160	6	9		25	47.7		
	SHR8 - 160	8	11		32	47.7		
	SHR10-160	10	13		32	28.6		
SR20	SHR6 - 160	6	9	20	25	95		h6
	SHR8 - 160	8	11		32	85.9		
	SHR10-160	10	13		32	66.8		
	SHR12-160	12	15		38	47.7		

切削工具SHANKØ 区分	Ø3-6	Ø6.1-10	Ø10.1-14	Ø14.1-18	Ø18.1-24	Ø24.1-30	Ø30.1-40
h6	0-8um	0-9um	0-11um	0-11um	0-13um	0-13um	0-16um

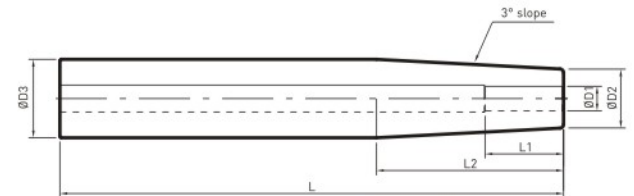
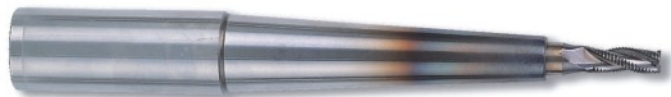

For Solid Carbide mm

订货型号-L		D1	D2	D3	L1	L2	L	Shank Tolerance
SR20	SHR 6 - 300	6	12	20	25	76.3	300	h6
	SHR 8 - 300	8	14					
SR25	SHR 8 - 300	8	14	25	32	124		
	SHR10 - 300	10	16					
	SHR12 - 300	12	18					
	SHR14 - 300	14	20					
SR32	SHR16 - 300	16	22	32	38	190.8		
	SHR10 - 300	10	16					
	SHR12 - 300	12	18					
	SHR14 - 300	14	20					
	SHR16 - 300	16	22					
	SHR20 - 300	20	26		42			

直柄側鎖式ER彈性筒夾刀柄-SL柄

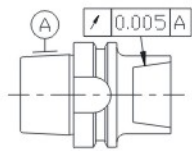
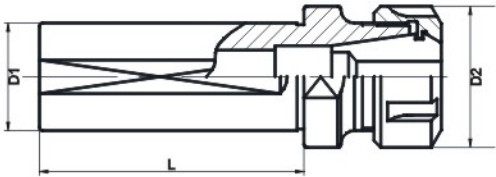
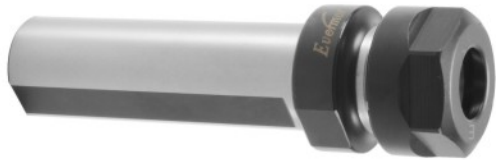

注：D型為雙頭ER結構

訂貨型號	ØD1	ØD2	訂貨型號	ØD1	ØD2	
SL16-ER11-70	16	19	-ER25-70	25	42	
-ER16-70		30	-80		42	
SL20-ER11-50D	20	19	SL32-ER20-80	32	34	
-ER11-70		19	-ER25-70		42	
-ER16-70		30	-80		42	
-100		30	-ER32-80		50	
-120		30	-130		50	
-ER20-80		34	-ER40-70	63		
-100		34	SL40-ER25-80	40	42	
-120		34	-ER32-80		50	
SL25-ER16-70		25	30		-135	50
-ER20-80			34		-ER40-80	63

★以上規格均不含扳手及筒夾，如有需要請另外訂購。

直柄ER彈性筒夾刀柄-BC柄

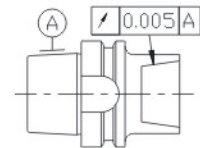
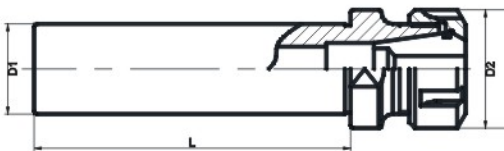

★以上規格均不含扳手及筒夾，如有需要請另外訂購。

訂貨型號	ØD1	ØD2	訂貨型號	ØD1	ØD2	
BC16-ER11-120	16	19	BC25-ER16-130	25	30	
-130		19	-170 *		34	
-ER16-130		30	-ER20-130		42	
BC20-ER16-120	20	30	-170 *		42	
-180 *		30	-ER25-130	32	42	
-ER20-120		34	-170 *		50	
-150		34	BC32-ER25-130		32	42
-170 *		42	-170 *	50		
-ER25-120		42	-ER32-80	50		50
-170 *		50	-130			50
-ER32-100	50	-170 *	-170 *			

*注：當選用L>150的產品時，不得用于橫向銑削加工，否則可能產生振刀。

直柄ER彈性筒夾刀柄-BC柄

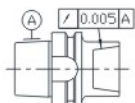
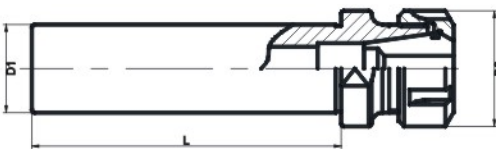

●M型使用小徑ER螺母

訂貨型號	ØD1	ØD2	訂貨型號	ØD1	ØD2
BC16-ER11-120M	16	17.5	BC25-ER16-120M	25	23.5
-ER16-120M		23.5	-170M *		28
BC20-ER16-100M	20	23.5	-ER20-120M		25
-120M		23.5	-170M *		
-150M		23.5	-ER25-120M		
-ER20-100M		28	-170M *		
-120M		28	-210M *		
-150M		28			
-170M *	28				

*注：當選用L>150的產品時，不得用于橫向銑削加工，否則可能產生振刀。

★以上規格均不含扳手及筒夾，如有需要請另外訂購。

C/ER直柄延长杆(M型小径螺帽)

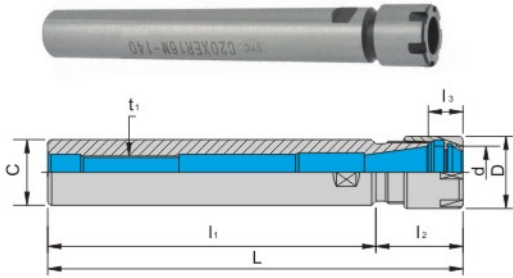

訂貨型號	l ₁	L	l ₂	l ₃	D	t ₁
C 8 x ER8M-55	79	24	17	6	12	M4 x 0.7P
C10 x ER8M-100	117					
C10 x ER8M-150	167					
C10 x ER8M-180	197					
C12 x ER8M-55	72					
C12 x ER8M-120	137		26.5			
C12 x ER8M-180	197					
C12 x ER11M-80	96.6	16.6	6.6	16	M5 x 0.8P	

MTA有扁尾莫氏锥柄ER弹性筒夹刀柄-MTA柄

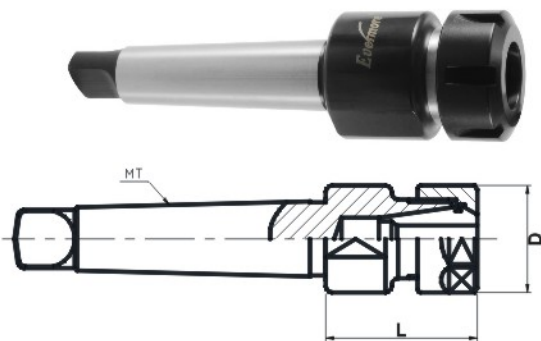

訂貨型號-L	Ø D	MT No.
MTA2-ER16-40	30	2
-ER25-60	42	
-ER32-65	50	
MTA3-ER20-50	34	3
-ER25-60	42	
-ER32-65	50	
MTA4-ER25-60	42	4
-ER32-65	50	
-ER40-70	63	

MTA无扁尾莫氏锥柄ER弹性筒夹刀柄-MTB柄

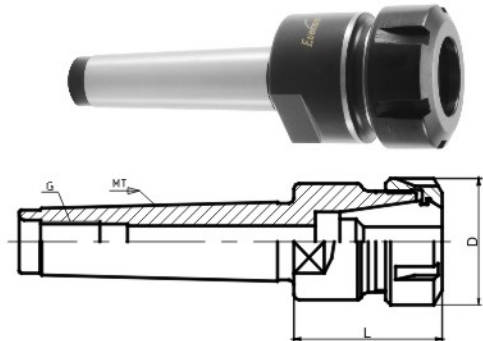

訂貨型號-L	Ø D	MT No.	G
MTB3-ER32-65	50	3	M12
MTB4-ER32-65	50	4	M16
-ER40-80	63		
MTB5-ER40-80	63	5	M20

★ 以上規格均不含扳手及筒夾，如有需要請另外訂購。

C/SL 直柄侧固延长小径刀柄

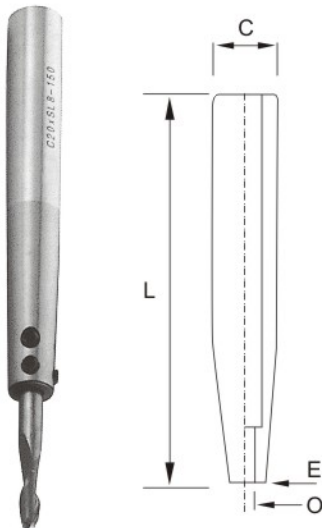

訂貨型號-L	C h7	D h5	L	E	螺絲規格
C10-SL03-150	10	3	150	9	M3-0.5P
C10-SL04-150	10	4	150	9	M4-0.7P
C10-SL06-150	10	6	150	10	M4-0.7P
C12-SL04-150	12	4	150	9	M4-0.7P
C12-SL06-150	12	6	150	10	M4-0.7P
C16-SL04-150	16	4	150	10	M4-0.7P
C16-SL04-200	16	4	200	10	M4-0.7P
C16-SL06-150	16	6	150	13	M4-0.7P
C16-SL06-200	16	6	200	13	M4-0.7P
C16-SL08-150	16	8	150	15	M4-0.7P
C16-SL08-200	16	8	200	15	M4-0.7P
C20-SL06-150	20	6	150	13	M4-0.7P
C20-SL06-200	20	6	200	13	M4-0.7P
C20-SL08-150	20	8	150	15	M6-1.0P
C20-SL08-200	20	8	200	15	M6-1.0P
C20-SL10-150	20	10	150	17	M6-1.0P
C20-SL10-200	20	10	200	17	M6-1.0P
C20-SL12-150	20	12	150	19	M6-1.0P
C20-SL12-200	20	12	200	19	M6-1.0P

材質採用抗震性優越的鍍鉻合金鋼

M型螺帽双头AR筒夹刀杆

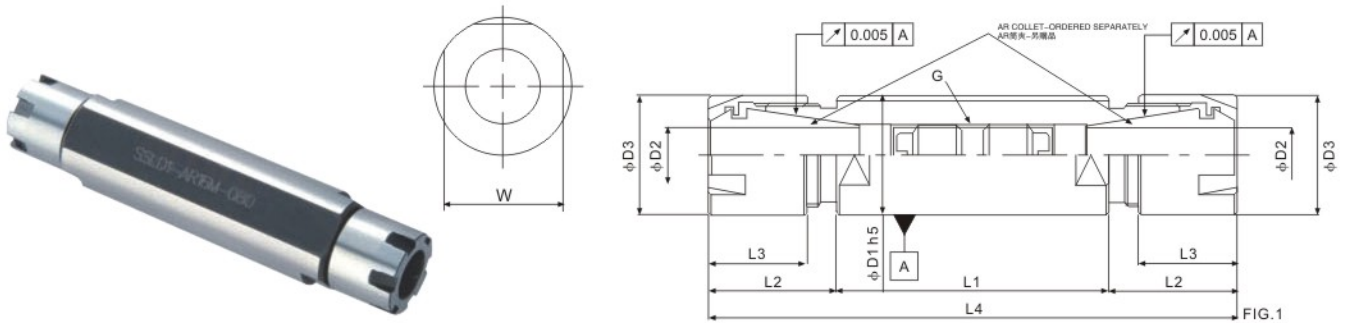

订货型号-L	D (mm)	夹持范围D1(mm)	D2(mm)	L(mm)	L1(mm)	L2(mm)	L3(mm)	W(mm)	类型
SD16-ER11M-80L	16	0.5-7.0	16	48	80	16	12	14	2
SD16-ER11M-90L	16	0.5-7.0	16	58	90	16	12	14	2
SD16-ER11M-110L	16	0.5-7.0	16	78	110	16	12	14	2
SD3/4-ER11M-80L	19.05	0.5-7.0	16	48	80	16	12	17	2
SD3/4-ER11M-110L	19.05	0.5-7.0	16	78	110	16	12	17	2
SD3/4-ER11M-130L	19.05	0.5-7.0	16	98	130	16	12	17	2
SD3/4-ER16M-110L	19.05	0.5-10.0	22	64	110	23	18.5	17	2
SD20-ER11M-70L	20	0.5-7.0	16	38	70	16	12	17	2
SD20-ER11M-90L	20	0.5-7.0	16	58	90	16	12	17	2
SD20-ER11M-105L	20	0.5-7.0	16	73	105	16	12	17	2
SD22-ER16M-90L	22	0.5-10.0	22	44	90	23	18.5	19	2
SD22-ER16M-115L	22	0.5-10.0	22	69	115	23	18.5	19	2
SD22-ER16M-122L	22	0.5-10.0	22	76	122	23	18.5	19	2
SD22-ER16M-137L	22	0.5-10.0	22	91	137	23	18.5	19	2
SD25-ER16M-120L	25	0.5-10.0	22	74	120	23	18.5	22	2
SD 1"-ER16M-85L	25.4	0.5-10.0	22	39	85	23	18.5	22	2
SD 1"-ER16M-120L	25.4	0.5-10.0	22	74	120	23	18.5	22	2
SD32-ER20M-110L	32	0.5-13.0	28	66	120	27	19	27	2
SD32-ER20M-130L	32	0.5-13.0	28	66	120	27	19	27	2

双头AR筒夹刀杆

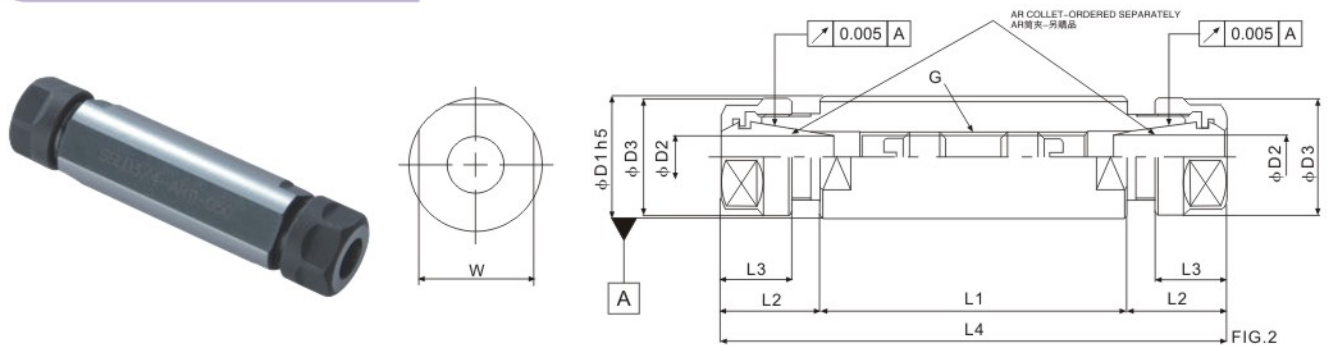

订货型号-L	D (mm)	夹持范围D1(mm)	D2(mm)	L(mm)	L1(mm)	L2(mm)	L3(mm)	W(mm)	类型
SD3/4-ER11-65L	19.05	0.5-7.0	19	33	65	16	11.5	17	1
SD3/4-ER11-85L	19.05	0.5-7.0	19	53	85	16	11.5	17	1
SD20-ER11-65L	20	0.5-7.0	19	33	65	16	11.5	17	1
SD20-ER11-85L	20	0.5-7.0	19	53	85	16	11.5	17	1

前锁六角式圆柄刀杆

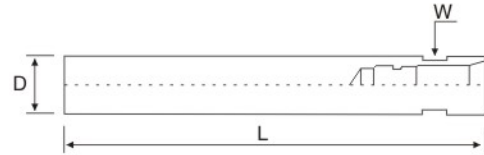

整支通孔，利于高转速及防震。

订货型号-L	L	D	A(扳手)	Collet
EC0410-080	80	10	8	EC4-0.6-4.2
EC0410-150	150	10	8	
EC0512-100	100	12	10	EC5-0.6-5.5
EC0512-150	150	12	10	
EC0512-200	200	12	10	
EC0616-100	100	16	14	EC6-0.6-7.0
EC0616-150	150	16	14	
EC0616-200	200	16	14	
EC0620-100	100	20	17	EC9-1.0-10.0
EC0920-150	150	20	17	
EC0920-200	200	20	17	
EC0920-300	300	20	17	
EC1225-100	100	25	23	EC12-2.0-12.7
EC1225-150	150	25	23	
EC1225-200	200	25	23	
EC1225-300	300	25	23	

丝攻筒夹尺寸参照表

公制	美制	英制	直径 φ	四角 □
M1 M2	0# 1#		T3	2.5
M2.6	2# 3# 4#		T3	2.5
M3	5# 6#	W1/8	T4	3.2
M4 M4.5	8#	W5/32	T5	4
M5 M5.5	10# 12#	W3/16	T5.5	4.5
M6	U1/4	W1/4	T6	4.5
	U5/16	W5/16	T6.1	5
M8 M7			T6.2	5
M10 M9	U3/8	W3/8	T7	5.5
M11	U7/16	W7/16	T8	6
M12			T8.5	6.5
	U1/2	W1/2	T9	7

丝攻延长刀杆组 (套装)

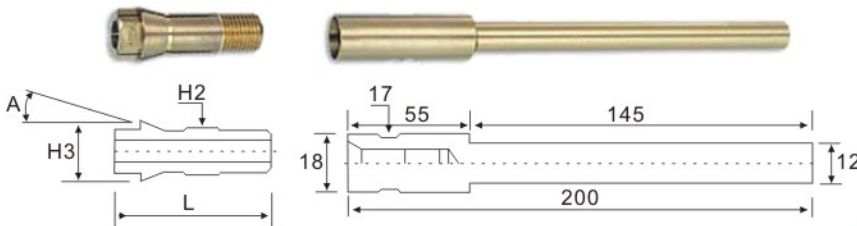

订货型号-L	丝攻筒夹(JIS)
EC1218-200L	T4 T5 T6 T6.1 T7 T8 T8.5 T9



EC 六角弹性筒夹

- 筒夹内为内牙阻擋螺絲，装入刀杆前可任意調整孔内刀刃的長度。
- T型筒夾系列為絲攻的柄徑及四方孔的標示。
- H型筒夾系列規格內孔為H5公差值。
- EC形筒夾每單位為0.1m/m。

订货型号-L		L	H2	H3	W	Shank
EC4	H1 0.6-4.2	2.5	6.5	8.3	6	EC10
	T3 T4					
EC5	H1 0.6-5.5	31	8.5	11	8	EC12
	T3 T4 T5					
EC6	H1 0.6-7.0	36	10	12.95	10	EC16
	T3 T4 T5 T5.5 T6 T6.1 T6.2 T6.3					
EC9	H1 1.0-10.0	46	13	17.29	14	EC20
	T3 T4 T5 T5.5 T6 T6.1 T6.2 T6.3 T7 T8 T8.2 T8.5 T9					
EC12	H1 1.0-12.7	52	16.5	21.59	17	EC25
	T3 T4 T5 T5.5 T6 T6.1 T6.2 T6.3 T7 T8 T8.2 T8.5 T9 T9.5 T10.5 T11 T12 T12.5					

DC小径夹头

- 没有螺帽的小径夹头设计,能使外径最小值达到 $\phi 8.6\text{mm}$,在深部加工时,具有延伸刀具的良好效果。
- 备有各种不同长度的延长杆可供选择:最长可达300mm。

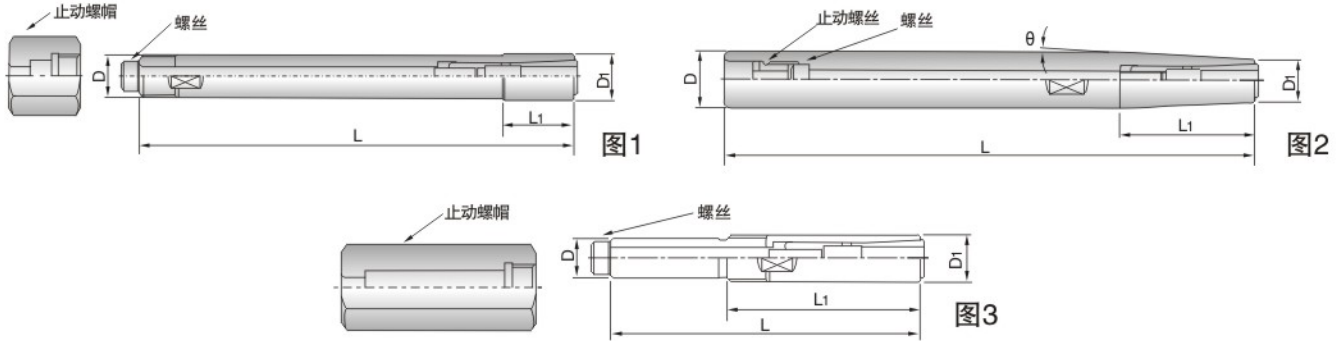

订货型号	图号	d	L	L1	D	D1	θ	筒夹	扳手	螺丝	止动螺丝	止动螺帽
ST08-DC4-80	1	2~4	80	16.5	8	8.6	--	DC4	30194~632(M3)	M4L60	--	TP-M8
ST12-DC4-120	2	2~4	120	38	12	8.6	3°	DC4	30194~632(M3)	M4L85	OP-M8	--
ST10-DC6-80	3	2~6	80	50	10	13	--	DC6	30194~642(M4)	M5L55	--	TP-M12A
ST12-DC6-120	1	2~6	120	40	12	13	--	DC6	30194~642(M4)	M5L95	--	TP-M12
ST16-DC6-150	2	2~6	150	38	16	13	3°	DC6	30194~642(M4)	M5L100	OP-M10	--
ST20-DC6-200	2	2~6	200	70	20	13	3°	DC6	30194~642(M4)	M5L100	OP-M10	--
ST25-DC6-250	2	2~6	250	115	25	13	3°	DC6	30194~643(M4)	M5L100	OP-M10	--
ST20-DC8-150	2	3~8	150	28	20	19	2°	DC8	30194~652(M5)	M6L70	OP-M12	--
ST20-DC8-200	2	3~8	200	28	20	19	2°	DC8	30194~652(M5)	M6L120	OP-M12	--
ST25-DC10-150	2	3~10	150	28	25	24	2°	DC10	30194~662(M6)	M8L80	OP-M16	--
ST25-DC10-200	2	3~10	200	28	25	24	2°	DC10	30194~662(M6)	M8L100	OP-M16	--
ST25-DC10-250	2	3~10	250	28	25	24	2°	DC10	30194~662(M6)	M8L150	OP-M16	--
ST32-DC12-200	2	3~12	200	57	32	30	2°	DC12	30194~682(M8)	M10L120	OP-M18	--
ST32-DC12-250	2	3~12	250	57	32	30	2°	DC12	30194~682(M8)	M10L150	OP-M18	--
ST32-DC12-300	2	3~12	300	57	32	30	2°	DC12	30194~682(M8)	M10L150	OP-M18	--

DC-E筒夹(立铣刀使用)

- DC-E筒夹设计重点是强调立铣刀的挟持力



订货型号		L	ϕD
筒夹系列	ϕd		
DC6-	3E,3.175E,4E,6E,6.35E	36	9.6
DC8-	3E,4E,6E,8E	45	15
DC10-	3E,4E,6E,8E,10E	52	19.1
DC12-	3E,4E,5E,6E,8E,10E,12E	60	22

跳动精度 < 5 μm

DC筒夹

- DC6筒夹,可挟持 $\phi 6\text{mm}$ 以下的钻头、铰刀、丝攻及铣刀。
- 每一个筒夹的挟持范围为0.25mm。

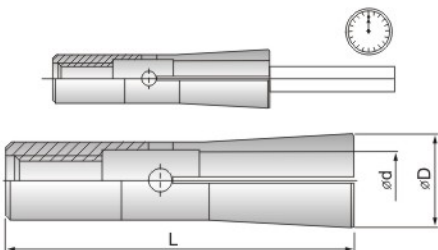

订货型号		L	ϕD
筒夹系列	ϕd		
DC6-	2,2.25,2.5,2.75,3,3.25 3.5,3.75,4,4.25,4.5,4.75 5,5.25,5.5,5.75,6	36	9.8

直柄側固式WER攻牙刀柄-SL柄

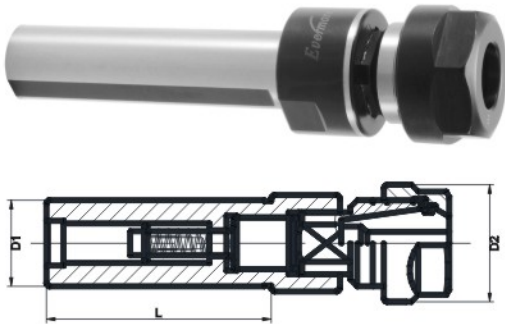

訂貨型號	ØD1	ØD2	筒夾型號
SL20-WER16-80	20	30	ER16
-WER20-80		34	ER20
SL25-WER16-80	25	30	ER16
-WER20-80		34	ER20
-WER25-80		42	ER25
SL32-WER25-80	32	42	ER25
-WER32-80		50	ER 32

★ 以上規格均不含扳手及筒夾，如有需要請另外訂購。

直柄WER攻牙刀柄-BC柄

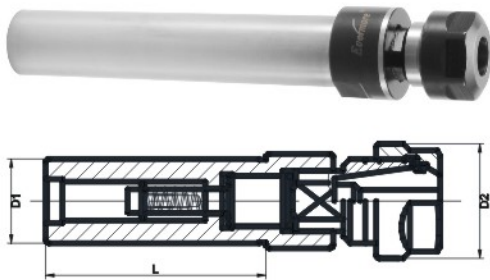

訂貨型號	ØD1	ØD2	筒夾型號
BC20-WER16-130	20	30	ER16
-WER20-130		34	ER20
BC25-WER16-130	25	30	ER16
-WER20-130		34	ER20
-WER25-130		42	ER25
BC32-WER25-130	32	42	ER25
-WER32-130		50	ER 32

★ 以上規格均不含扳手及筒夾，如有需要請另外訂購。

WF 快換式攻牙刀把(伸縮型)

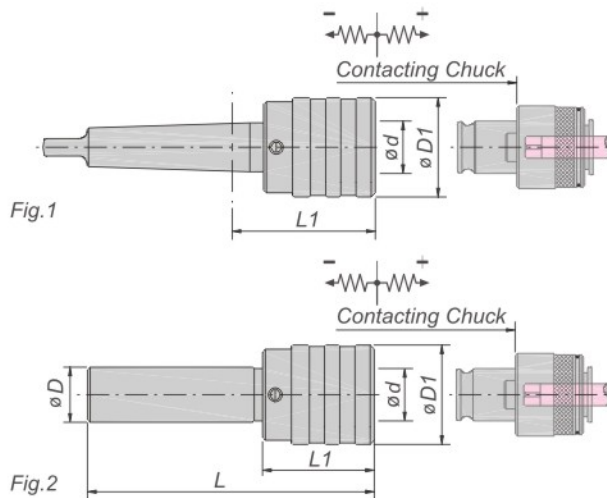

訂貨型號-L	Fig.	攻牙範圍	ød	øD	øD1	L	L1	伸縮長度		絲攻筒夾
								壓縮	伸長	
MT2-WF12	1	M03 ~ M12	19	-	36	-	48	7.5	7.5	TC312
MT3-WF20		M08 ~ M20	31		53		70	12.5	12.5	TC820
MT4-WF20			48		78		71	20.0	20.0	TC1433
MT4-WF33										
ST20-WF12	2	M03 ~ M12	19	20	36	113	43	7.5	7.5	TC312
ST25-WF20		M08 ~ M20	31	25	53	145	65	12.5	12.5	TC820
ST32-WF20			32							

一體式鑽夾頭



主要特點 Main Features:

- ※結構緊密。
- ※把傳統結構中柄與夾頭連接產生的誤差減小到最小。
- ※能防止夾頭脫落。
- ※操作安全。

訂貨型號	夾持能力	錐孔類型	ØD	訂貨型號	夾持能力	錐孔類型	ØD
INT-3	0.5-3.175 1/64" -1/8"	MT1	25	INT-13	0.5-13 1/64" -1/2"	JC1	50.5
		JC 1/2"				JC32	
		JC12				JC 1	
INT-8	0.5-8 1/64" -5/16"	MT2	35	INT-16	3-16 1/8" -5/8"	R8	56
		JC20				MT3	
		JC 3/4"				MT4	
INT-13	0.5-13 1/64" -1/2"	50.5	JC20			JC20	
		JC 3/4"	JC 3/4"				
		JC25	JC25				
		JC 3/4"	JC1				
		JC25	JC32				
		JC 3/4"	JC1 1/4"				
		JC25	JC1 1/4"				

一體式主軸更優于傳統設計。

XHSP型鑽夾頭



主要特點

- ※針對強扭矩場合的特殊設計和製造；
- ※先進的檢測儀器保證了優良的精度要求，夾緊力是其他同類產品的兩倍；
- ※配有鎖緊扳手，防止在使用過程中瞬時轉向改變而導致鑽頭脫落；
- ※特別適合于CNC中心機和銑床使用

訂貨型號	夾持能力	錐孔類型	ØD	A	B
6XHSP	0.5-6.5 1/64" -1/4"	B12	34	69	61
		J1			
		B10			
8XHSP	0.5-8 1/64" -5/16"	J2S	34	69	61
		B10			
		J1			
10XHSP	0.5-10 1/64" -3/8"	B12	43	92	81
		J33			
		J2			
		J2S			
		B12			
13XHSP	0.5-13 1/64" -1/2"	B16	51.5	103	92
		J6			
		J2			
		J33			
16XHSP	3-16 1/8" -5/8"	B16	58	108	95
		J6			
		J33			
		B16			
SP-8XHSP	8XHSP扳手				
SP-10XHSP	10XHSP扳手				
SP-13XHSP	13XHSP扳手				
SP-16XHSP	16XHSP扳手				

XH型鑽夾頭



主要特點

- ※適用于銑床、鑽床及重型鑽加工；
- ※高精度超強鑽夾頭；
- ※剛性好，扭矩大

訂貨型號	夾持能力	錐孔類型	ØD	A	B
6XH	0.5-6.5 1/64" -1/4"	J1	34	69	61
		B10			
		B12			
8XH	0.5-8 1/64" -5/16"	J1	34	69	61
		J2S			
		B10			
10XH	0.5-10 1/64" -3/8"	B12	43	92	81
		J2S			
		J2			
		J33			
		B12			
13XH	0.5-13 1/64" -1/2"	B16	51.5	103	92
		J2			
		J6			
		J33			
16XH	3-16 1/8" -5/8"	B16	58	108	95
		J6			
		B16			
		B18			
		J3			